

1 PROPOSED BY: Public Works - Engineering

2 INTRODUCTION DATE: _____

3
4 ORDINANCE NO. _____

5 REGARDING TEMPORARY INSTALLATION OF STOP SIGNS
6 AT THE INTERSECTION OF BERTHUSEN ROAD AND LOOMIS TRAIL ROAD DURING
7 CONSTRUCTION OF THE WEST BADGER ROAD BERTRAND CREEK BRIDGE #50
8 REPLACEMENT PROJECT
9

10 WHEREAS, in compliance with RCW 36.32.120 and 46.61.200, it is found necessary
11 and expedient to install traffic control signs on certain County Roads; and
12

13 WHEREAS, the existing Bridge #50 on West Badger at Bertrand Creek is scheduled to
14 be replaced; and
15

16 WHEREAS, design and permitting on the project is now complete and construction of
17 this project is expected to start in the summer of 2019 with completion anticipated in late 2019;
18 and
19

20 WHEREAS, during construction of this project West Badger Road will be closed at the
21 project site and local traffic will be detoured to Berthusen Road, Loomis Trail Road and
22 Weidkamp Road; and
23

24 WHEREAS, Public Works proposes installing temporary stop signs at the intersection of
25 Loomis Trail Road and Berthusen Road to improve the safety of this intersection during use of
26 this detour;
27

28 NOW, THEREFORE, BE IT ORDAINED by the Whatcom County Council that
29 temporary stop signs be installed at the intersection of Loomis Trail Road and Berthusen Road
30 as shown on page 2 of attached Exhibit A, the detour plan for the above-cited project, upon the
31 start of project construction; and
32

33 BE IT FURTHER ORDAINED that upon completion of the project the temporary stop
34 signs will be removed; and
35

36 BE IT FURTHER ORDAINED that the County Engineer is hereby directed to install the
37 appropriate signs and that the Whatcom County Sheriff be notified by a copy of this ordinance.
38

39 ADOPTED this ____ day of _____, 2019.
40

41
42 ATTEST:

WHATCOM COUNTY COUNCIL
WHATCOM COUNTY, WASHINGTON

43
44
45 _____
Dana Brown-Davis, Council Clerk

45 _____
Rud Browne, Council Chair

46
47
48 APPROVED AS TO FORM:

() Approved () Denied

49
50 
51 _____
52 Senior Deputy Prosecuting
53 Attorney - Civil Division

52 _____
Jack Louws, Executive

54 Date: _____

LEGEND

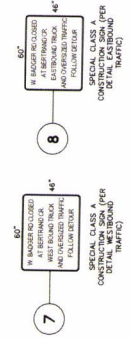
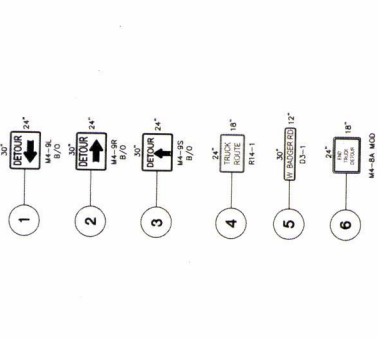
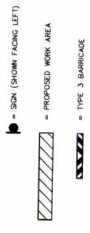

SIGN SPACING - X (1)
 TRAIL RIGGS - 45/25 MPH 500'±
 & RURAL RIGGS - 35/40 MPH 300'±
 BUSINESS DISTRICTS - 25/30 MPH 200'± (2)
 * EXAMPLE WITH W BANNER BG SIGN
 ALL SIGNS ARE BLACK ON ORANGE UNLESS SPECIFIED OTHERWISE
 (1) ALL SPACING MAY BE ADJUSTED TO ACCOMMODATE
 (2) THIS SIGN SPACING MAY BE REDUCED IN URBAN
 AREAS TO FIT ROADWAY CONDITIONS

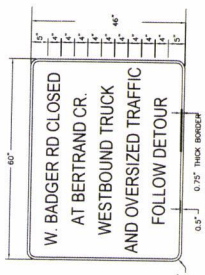
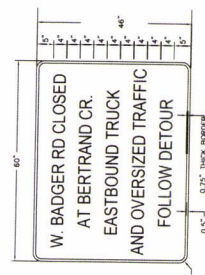
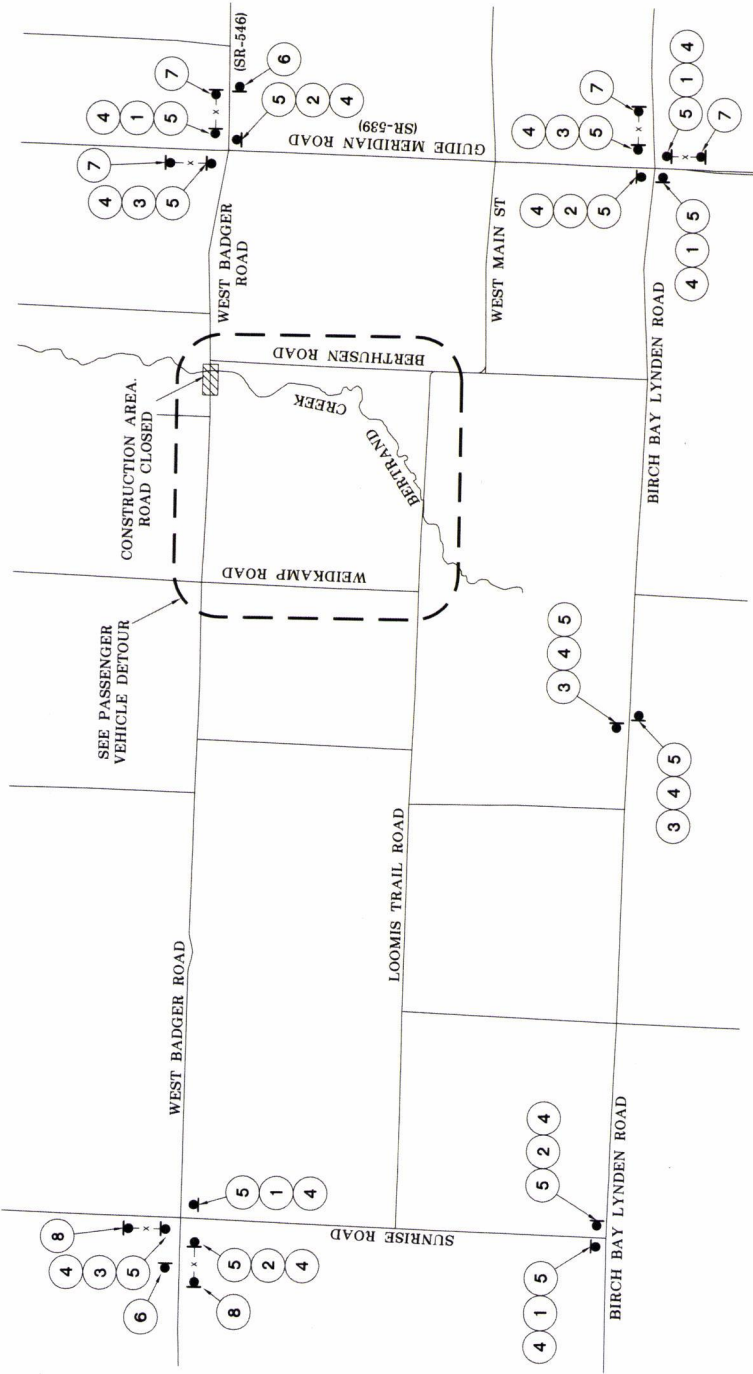

SPECIAL CONSTRUCTION SIGN
 EASTBOUND TRUCK TRAFFIC

SPECIAL CONSTRUCTION SIGN
 WESTBOUND TRUCK TRAFFIC

Know what's below.
 Call before you dig.
 Determina lo que está bajo tierra.
 Llámalo antes de excavar.



**EXHIBIT A -
 PAGE 1 OF 2**

DATE	BY	ISSUED	PLACED	EXTENSION
1				
2				
3				
4				

DATE	DESIGN	DRAWN	CHECK
PLAN	NIZ	EJR	NIZ
DATE	DATE	DATE	DATE
10/20/2015	10/20/2015	10/20/2015	10/20/2015

PROJECT WORKS DIVISION - JOLIET/CHICAGO
 PROJECT ENGINEER: JOSEPH P. BUDAN, P.E.
 PROJECT NUMBER: JASB001-11-01-01

DATE: 10/20/2015
 JOB NO: DEP 115264
 DRAWING NO: 115265-01-01-01-01
 SHEET NO: 115265-01-01-01-01-01

WHATCOM COUNTY
 DEPARTMENT OF PUBLIC WORKS
 122 N. COMMERCIAL ST. JOLIET, ILLINOIS 61781-1001

REICHARDT & EBE ENGINEERING INC
 1100 N. WASHINGTON ST. JOLIET, ILLINOIS 61781-1001

PROJECT: WEST BADGER ROAD / BERTRAND CREEK
 BRIDGE NO. 50 REPLACEMENT

TITLE: TRUCK DETOUR

SHEET: C9
 OF: 9 of 42

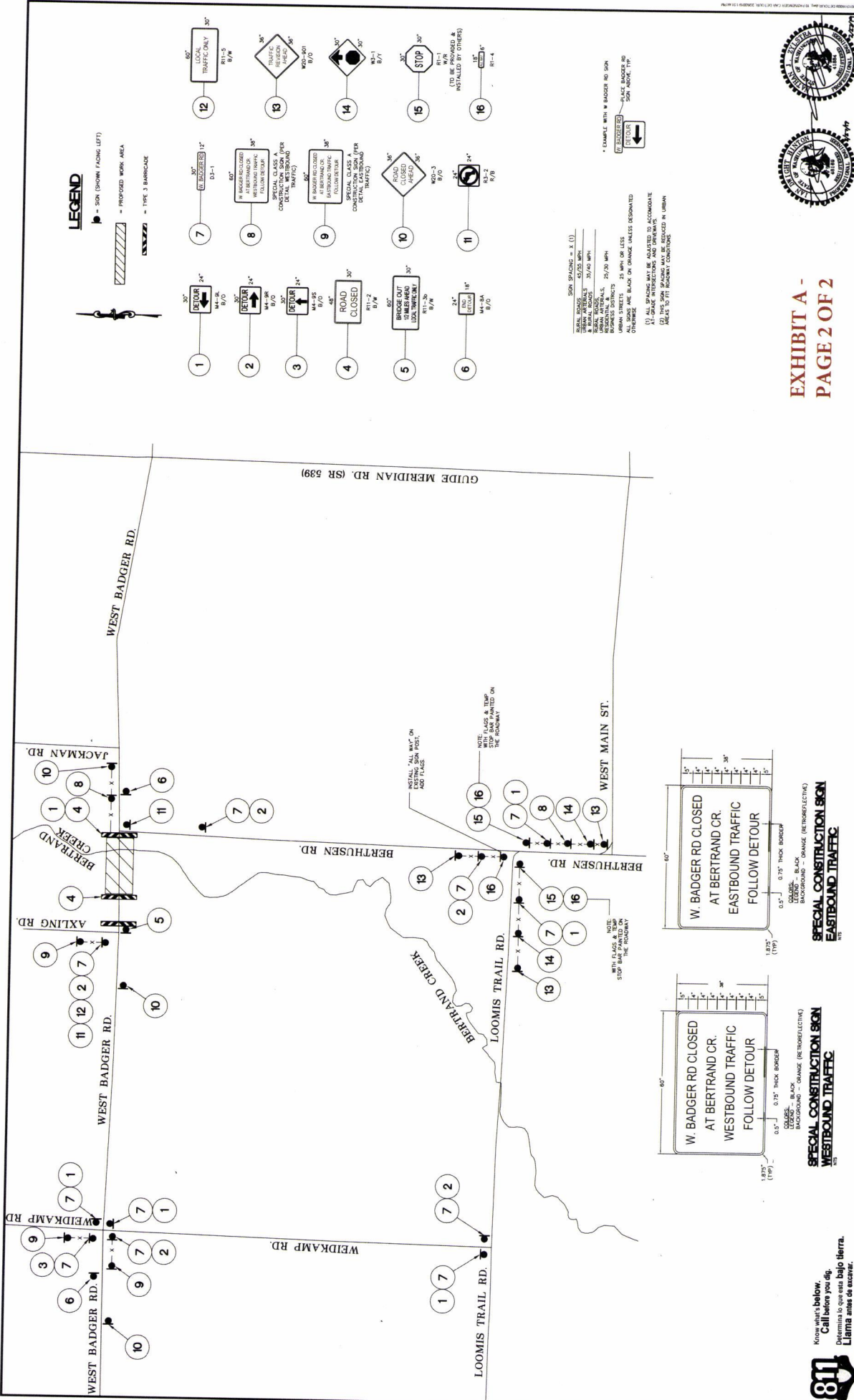

LEGEND

= SIGN (SHOW FACING LEFT)
 = PROPOSED WORK AREA
 = TYPE 3 BARRICADE

SIGN SPACING = 2 (1)
 RURAL ROADS 45/75 MPH
 & RURAL LOCALS 35/40 MPH
 URBAN ARTERIALS 25/30 MPH
 BUSINESS DISTRICTS
 URBAN STREETS 25 MPH OR LESS
 (1) ALL SPACINGS MAY BE ADJUSTED TO ACCOMMODATE
 SPECIAL SITUATIONS AND CONDITIONS
 (2) THIS SIGN SCHEDULE IS INTENDED FOR URBAN
 AREAS TO FIT EXISTING CONDITIONS

**EXHIBIT A -
PAGE 2 OF 2**



WHATCOM COUNTY DEPARTMENT OF PUBLIC WORKS 221 N. COMMERCIAL STREET, 4TH FLOOR MILWAUKEE, WI 53202		PROJECT: WEST BADGER ROAD / BERTRAND CREEK BRIDGE NO. 50 REPLACEMENT PASSENGER CAR DETOUR
R&E Reithardt & Elbe ENGINEERING, INC.		SHEET: C10 OF: 10 of 42
DATE: FEBRUARY 2013 DRAWN BY: JEP/ELB CHECKED BY: JEP/ELB PROJECT NUMBER: 10009 DETOUR.DWG	PUBLIC WORKS DIRECTOR: JON HUTCHINGS COUNTY ENGINEER: JOSEPH P. BRUNS, P.E. PROJECT ENGINEER: JAMES E. LEE, P.E.	DATE: _____ DRAWN BY: _____ CHECKED BY: _____ IN CHARGE: _____ SCALE: _____ SHEET NUMBER: _____

Know what's below.
 Call before you dig.
 Determine lo que está bajo tierra.
 Llámalo antes de excavar.

