



# Whatcom County

COUNTY COURTHOUSE  
311 Grand Avenue, Ste #105  
Bellingham, WA 98225-4038  
(360) 778-5010

## Agenda Bill Master Report

File Number: AB2021-134

---

<b>File ID:</b>	AB2021-134	<b>Version:</b>	1	<b>Status:</b>	Adopted
<b>File Created:</b>	02/22/2021	<b>Entered by:</b>	SHenthor@co.whatcom.wa.us		
<b>Department:</b>	Auditor's Office	<b>File Type:</b>	Ordinance Requiring a Public Hearing		
<b>Assigned to:</b>	Council	<b>Final Action:</b>	03/23/2021		
<b>Agenda Date:</b>	03/23/2021	<b>Enactment #:</b>	ORD 2021-010		

---

Primary Contact Email: Shenthor@co.whatcom.wa.us

### TITLE FOR AGENDA ITEM:

Ordinance amending Whatcom County Code Section 1.14, Electoral Precincts, for changes in certain voting precinct boundaries in Whatcom County

### SUMMARY STATEMENT OR LEGAL NOTICE LANGUAGE:

Seven (7) precincts need boundary line adjustments due to exceeding 1,500 active registered voters per RCW 29A.16.40(2). The precincts are 182, 201, 208, 225, 253, 302, and 604. Adjusting these boundary lines will affect adjacent precincts and create a new precinct. The precincts needing boundary line adjustments are 177, 182, 201, 202, 208, 213, 225, 227, 245, 253, 302, 603, 604 and the new precinct is 305.

### HISTORY OF LEGISLATIVE FILE

---

<b>Date:</b>	<b>Acting Body:</b>	<b>Action:</b>	<b>Sent To:</b>
03/09/2021	Council	INTRODUCED FOR PUBLIC HEARING	Council
		Aye: 5 Browne, Buchanan, Donovan, Frazey, and Kershner	
		Nay: 1 Elenbaas	
		Absent: 1 Byrd	
03/23/2021	Council	ADOPTED	
		Aye: 7 Browne, Buchanan, Byrd, Donovan, Elenbaas, Frazey, and Kershner	
		Nay: 0	
		Absent: 0	

---

**Attachments:** Proposed Ordinance

**PROPOSED BY: AUDITOR**  
**INTRODUCTION DATE: March 9, 2021**

**ORDINANCE NO. 2021-010**

**AMENDING WHATCOM COUNTY CODE SECTION 1.14, ELECTORAL PRECINCTS, FOR CHANGES IN CERTAIN VOTING PRECINCT BOUNDARIES IN WHATCOM COUNTY**

**WHEREAS**, seven (7) precincts need boundary line adjustments in Whatcom County Code Section 1.14 due to exceeding the limit of 1,500 active registered voters per RCW 29A.16.40(2). These precincts exceeding limit of 1,500 active registered voters are as follows; 182, 201, 208, 225, 253, 302, and 604. Adjusting these boundary lines also affects the adjacent precincts, and will also create a new precinct. In total the number of precincts needing boundary line adjustments is fourteen (14), as follows; 177, 182, 201, 202, 208, 213, 225, 227, 245, 253, 302, 305, 603, and 604, detailed in Exhibit A (page 2-8); and new individual precinct maps for each Precinct effected in Exhibit B (page 9-23).

**WHEREAS**, RCW 29A.16.040 requires the county legislative authority of each county in the state to divide the county into election precincts and establish the boundaries of the precincts; and

**WHEREAS**, RCW 29A.16.040 further provides that no precinct boundary changes may be made starting fourteen (14) days prior to the first day candidates may file for the primary election through the period ending with the general election; and

**WHEREAS**, the first day for candidates to file this year is the 17th day of May, 2021, and

**WHEREAS**, the affected Precincts 177, 182, 201, 202, 208, 213, 225, 227, 245, 253, 302, 305, 603, and 604 will result in new individual precinct maps to the "Book of Election Precinct Maps" previously adopted effective November 10, 2020; and

**WHEREAS**, RCW 29A.76.030 provides the County Auditor shall transfer and notify any registered voters that may be affected by the change in boundaries.

**NOW, THEREFORE, BE IT ORDAINED** by the Whatcom County Council that the change to the "Book of Election Precinct Maps," affecting Precincts 177, 182, 201, 202, 208, 213, 225, 227, 245, 253, 302, 305, 603, and 604 shall be adopted and substituted into the "Book of Election Precinct Maps;" said revised Book of Maps is available through the Whatcom County Council Office and online through the Election page at the Whatcom County Auditor's Office homepage.

**ADOPTED** this 23<sup>rd</sup> day of March, 2021.

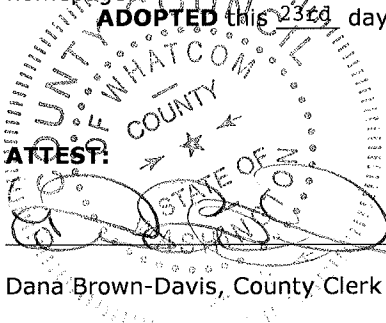
**ATTEST:**  
  
Dana Brown-Davis, County Clerk

**WHATCOM COUNTY COUNCIL**  
**WHATCOM COUNTY,**  
**WASHINGTON**



Barry Buchanan, Council Chair

**APPROVED AS TO FORM:**

  
Royce Buckingham approved by email 2/22/2021

Royce Buckingham, Civil Deputy Prosecutor

Approved ( ) Denied  

Satpal Sidhu, County Executive

Date: 3/25/2021

## Exhibit A

### Updating Precinct Lines - January 2020:

After reviewing precinct populations, there are 7 precincts over the limit of 1,500 active registered voters. Per RCW 29A.16.040(2), the number shall not exceed 1,500 active registered voters. We will need to adjust lines for Precincts 182, 201, 208, 225, 253, 302, and 604. Also changing will be the adjacent Precincts: 177, 202, 213, 227, 245, and 603. A new precinct (305) will need to be created to accommodate the changes in precinct 302.

Precinct Affected	Change Proposed	New Precinct
182	move portion into 177	177
201	move portion into 202	202
208	move portion into 213	213
225	move portion into 227	227
253	move portion into 245	245
302	split, create new precinct 305	305
604	move portion into 603	603

# Exhibit A

## Precinct 604

Solution: Move voters from 604 into 603. Move Portion A into 603. Use Line Rd and extension of Kamm Rd.

What it changes:  
Precinct 603  
Precinct 604

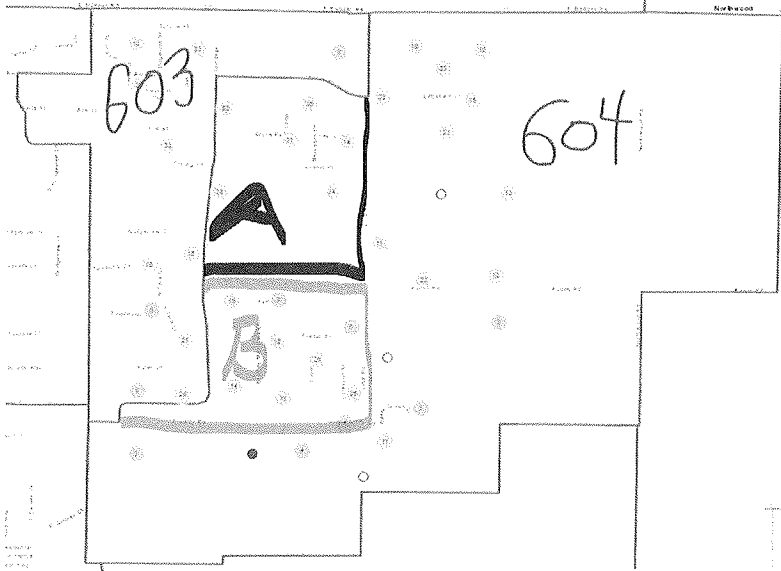

# Exhibit A

## Precinct 253

Solution: Move voters from 253 into 245. Move both Portion A and Portion B into Precinct 245.

What it changes (need new individual precinct maps):

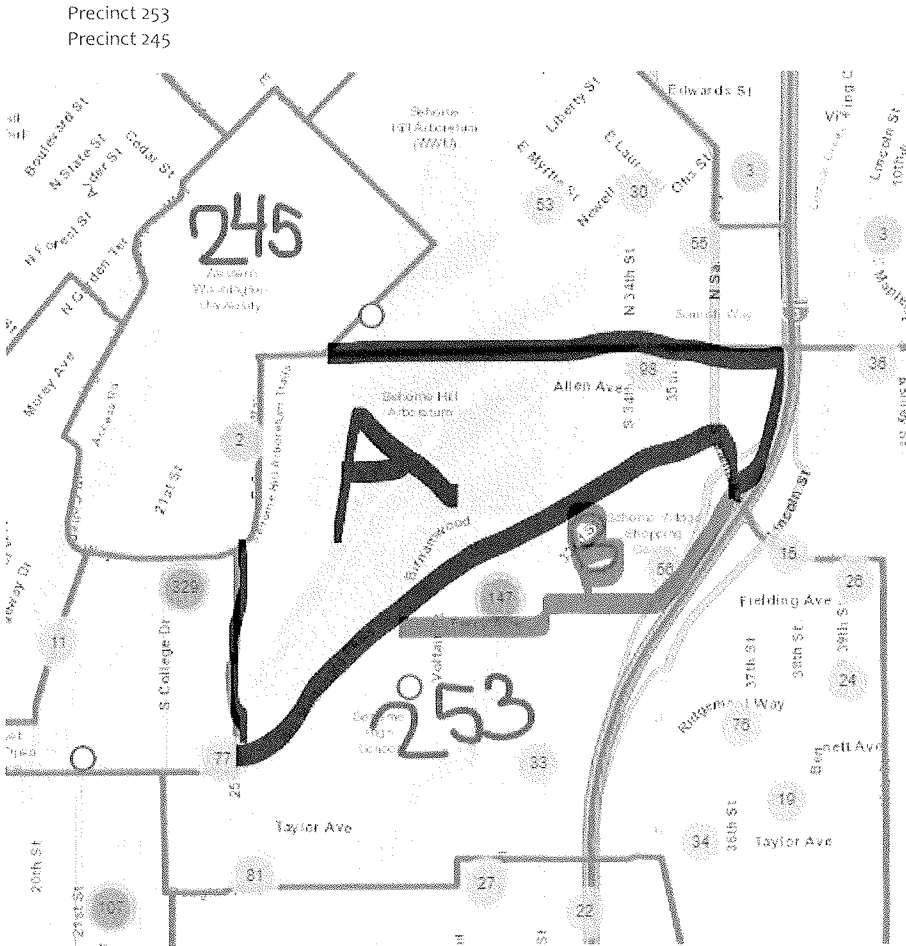

## Exhibit A

### Precinct 182

Solution: Move voters from 182.2 into Precinct 177.

What it changes (need new individual precinct maps):

Precinct 177  
Precinct 182

Move Precinct portion 182-2 into Precinct 177. This will create a new split in Precinct 177, and remove the split from 182.

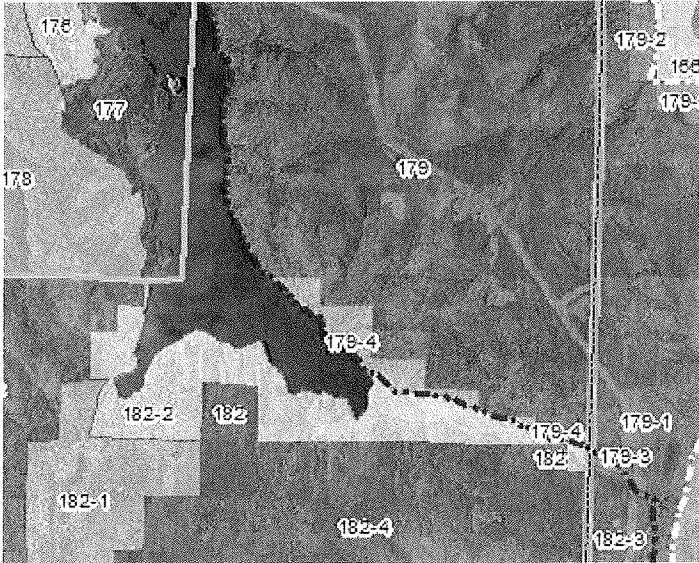

# Exhibit A

## Precinct 208

Solution: Move voters from 208 into Precinct 213. Move both Portion A & Portion B into Precinct 213.

What it changes:

- Precinct 208
- Precinct 213

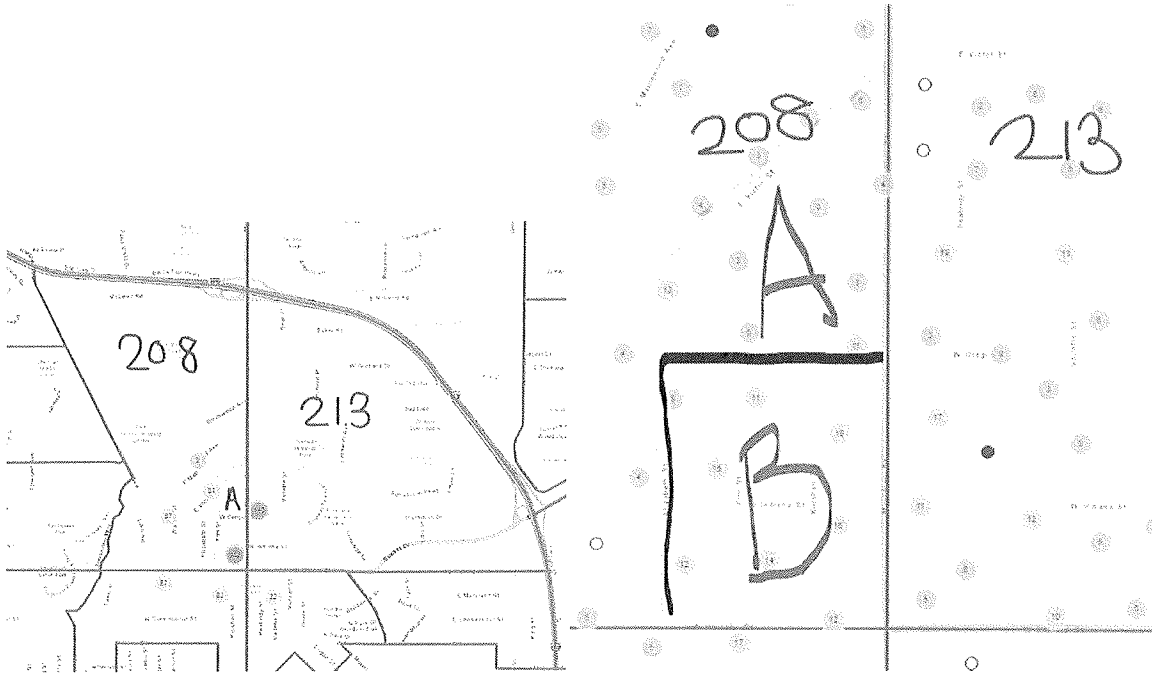



# Exhibit A

## Precinct 302

Solution: Create a new Precinct 305 & divide existing Precinct 302 in half. Use I-5/Adelia St/Harrison Ave/ St as cut-off.

What it changes:

- Precinct 302
- Creates new Precinct 305

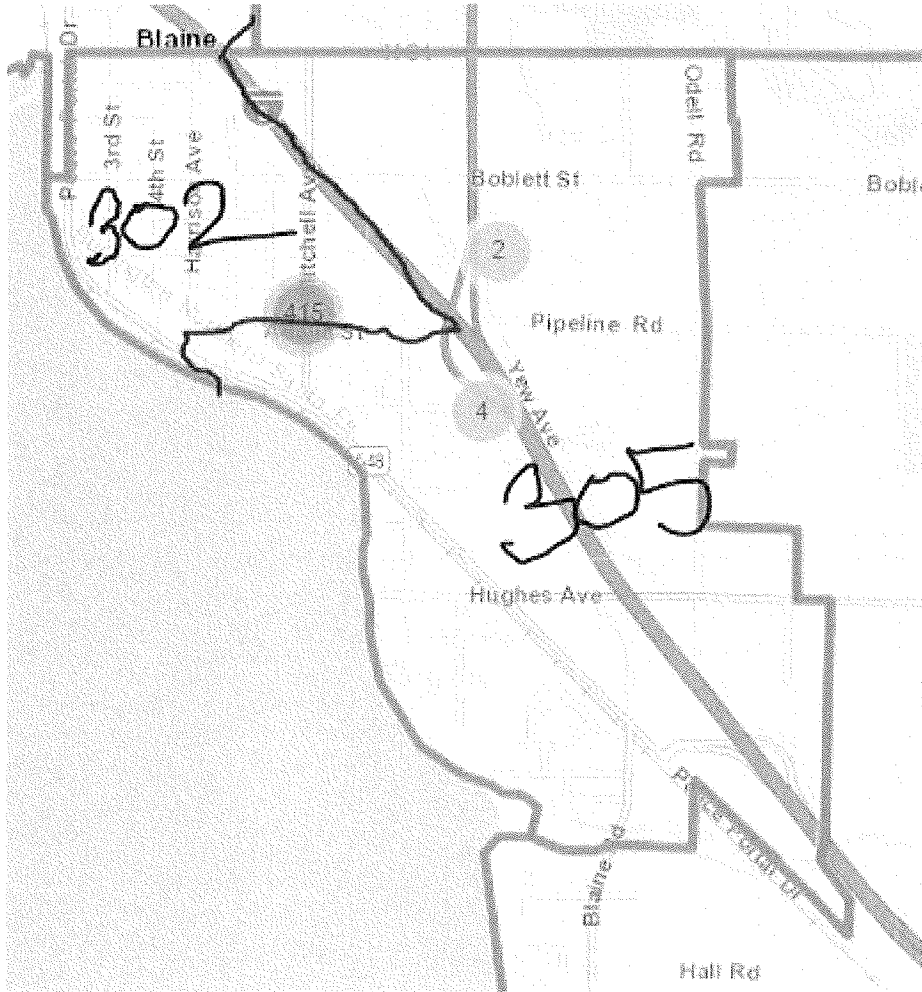

# Exhibit A

## Precinct 225

Solution: Move voters from 225 into Precinct 227. Extend Precinct 227 using B/Halleck/Cornwall Street.

What it changes:

- Precinct 225
- Precinct 227

Put pink portion (portion B) into Precinct 227, detailed bottom right (extend B Street boundary to Halleck St/Cornwall)

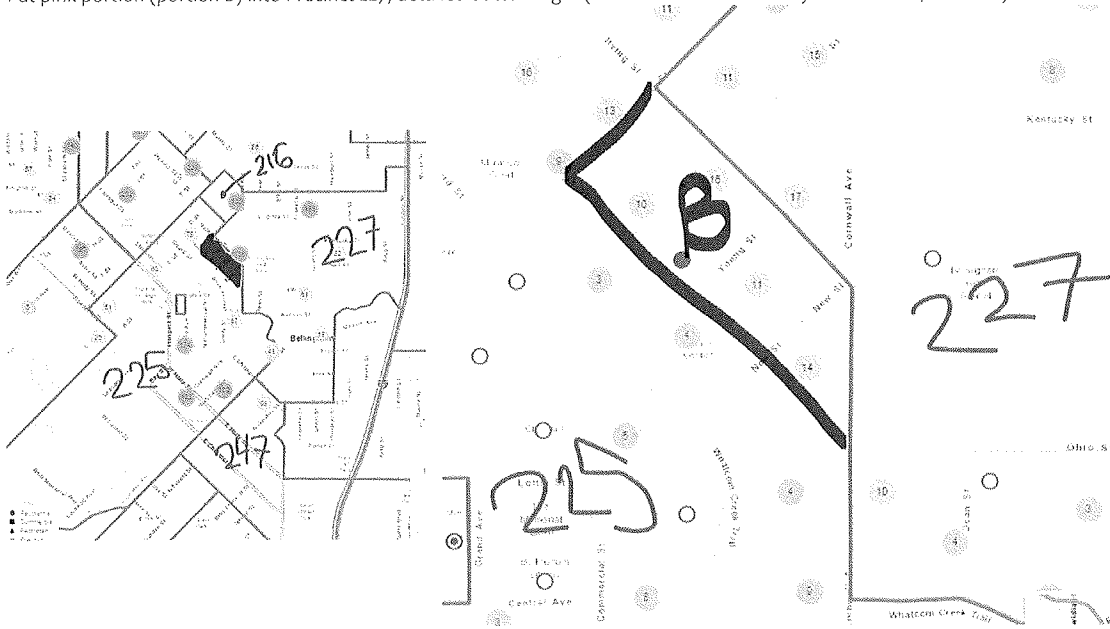

# Exhibit A

## Precinct 201

Solution: Move voters from 201-1 into 202-2. Move portion C below in to 202-2

What it changes:

- Precinct 201
- Precinct 202

Move portion C into 202-2. Use East Bear Creek as boundary

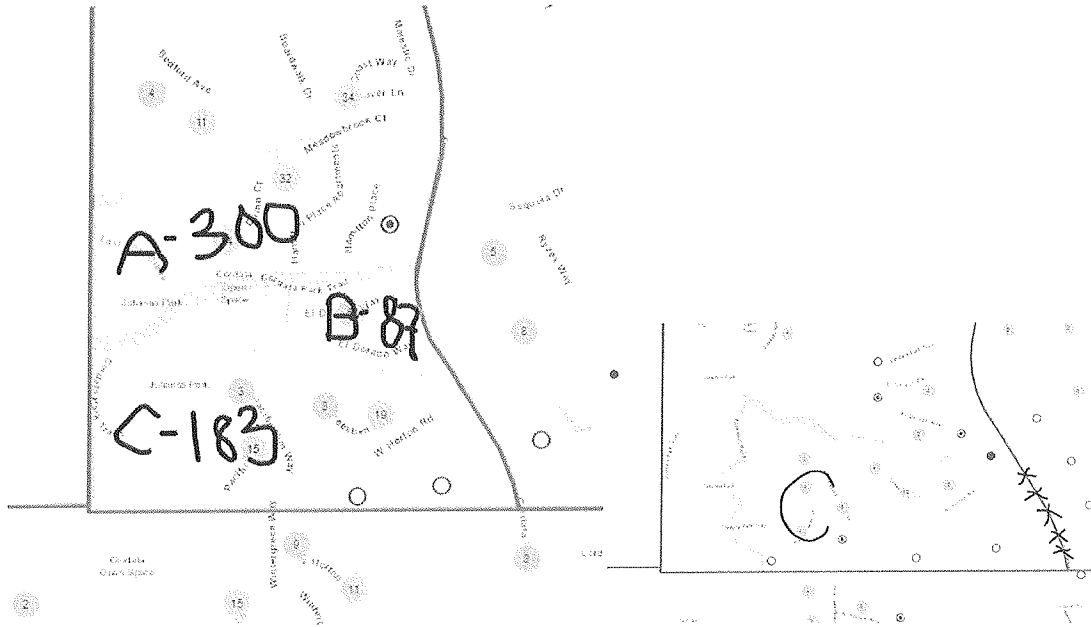

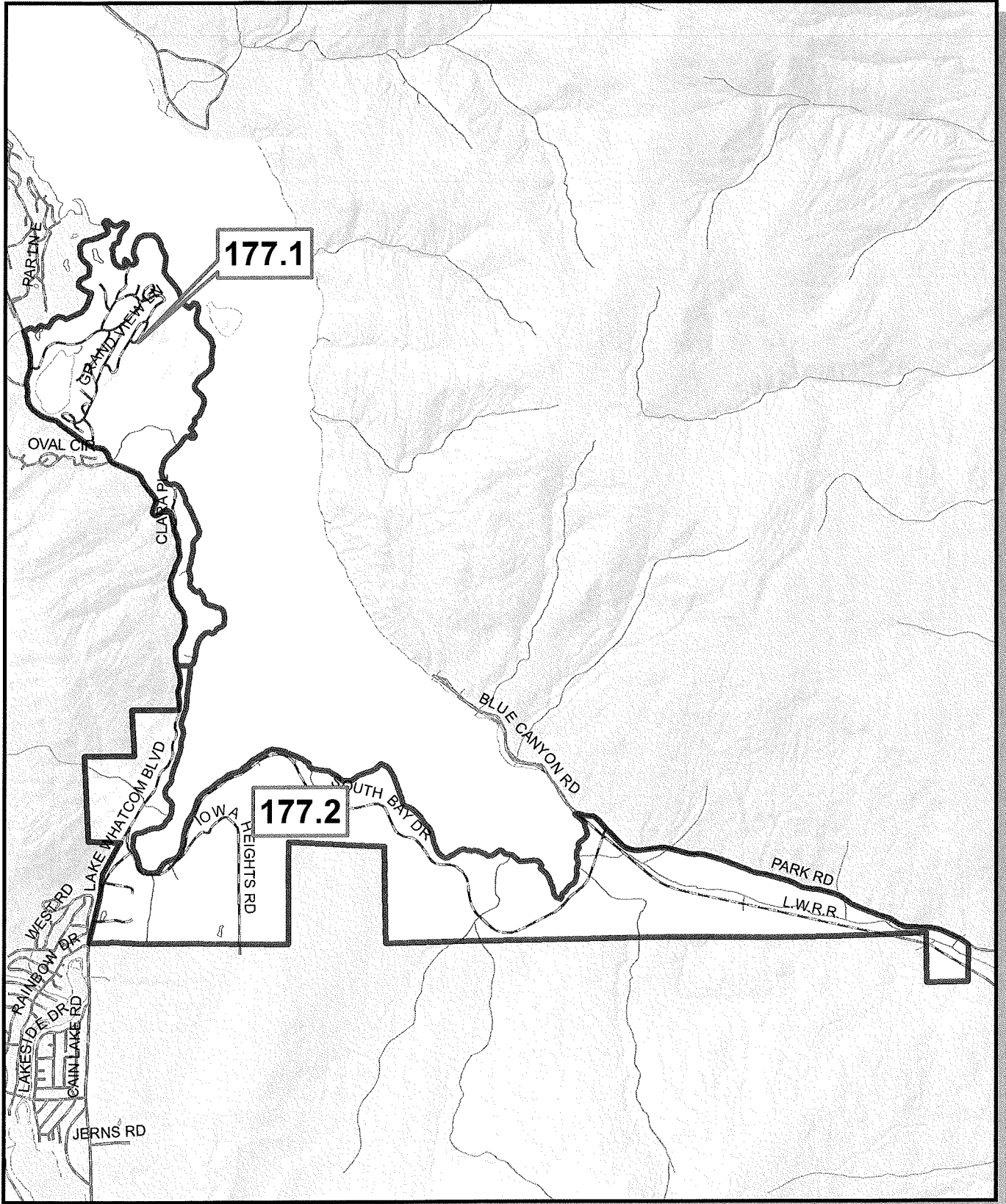

# Whatcom County Precinct 177

County Council District 3  
 Legislative District 40  
 Congressional District 2

USE OF WHATCOM COUNTY'S GIS DATA IMPLIES THE USER'S AGREEMENT WITH THE FOLLOWING STATEMENT:

Whatcom County disclaims any warranty of merchantability or warranty of fitness of this map for any particular purpose, or their express or implied. No representation or warranty is made concerning the accuracy, currency, completeness or quality of data depicted on this map. The user of this map does so at their own responsibility for use thereof, and further agrees to hold Whatcom County harmless from and against any damage, loss, or liability arising from any use of this map.

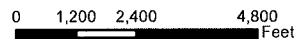

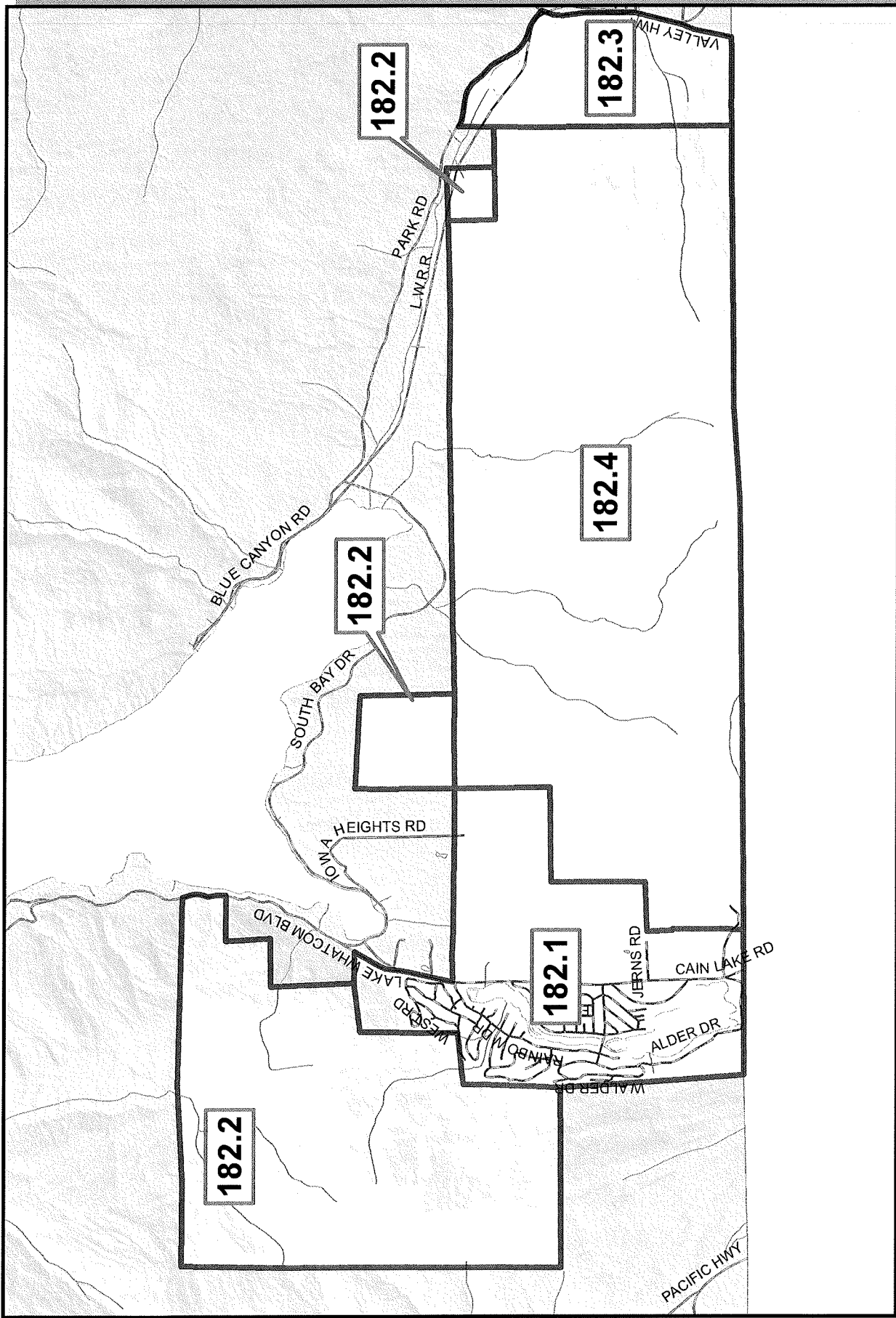

# Whatcom County Precinct 182

County Council District 3  
 Legislative District 40  
 Congressional District 2



USGS, AND OTHER DATA SOURCES TO WHICH THE USERS  
 OF THIS MAP ARE REFERRED. THE USER'S  
 RESPONSIBILITY TO OBTAIN AND VERIFY THE ACCURACY  
 OF ANY INFORMATION OBTAINED FROM THIS MAP IS  
 SOLELY THEIR OWN. THE USER'S USE OF THIS MAP  
 IS LIMITED TO THE PURPOSES FOR WHICH IT WAS  
 DESIGNED. THE USER'S USE OF THIS MAP FOR  
 ANY OTHER PURPOSE IS AT THEIR OWN RISK.



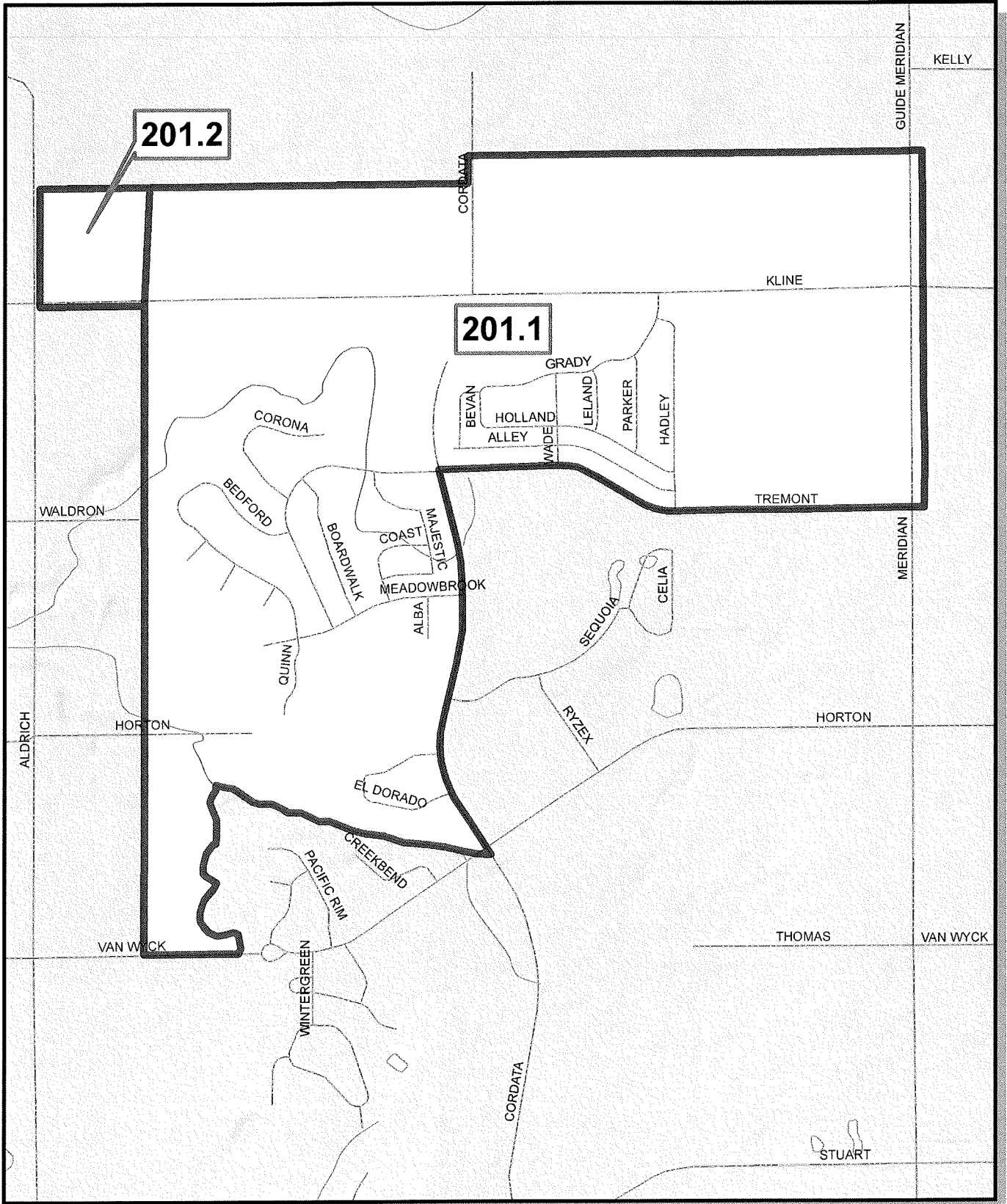

# Whatcom County Precinct 201

Ward 1  
 County Council District 4  
 Legislative District 42  
 Congressional District 2

USE OF WHATCOM COUNTY'S GIS DATA IMPLIES THE USER'S AGREEMENT WITH THE FOLLOWING STATEMENT:

Whatcom County disclaims any warranty of merchantability or warranty of fitness of this map for any particular purpose, either express or implied. No representation or warranty is made concerning the accuracy, currency, completeness or quality of data depicted on this map. Any user of this map assumes all responsibility for use thereof, and further agrees to hold Whatcom County harmless from and against any damage, loss, or liability arising from any use of this map.





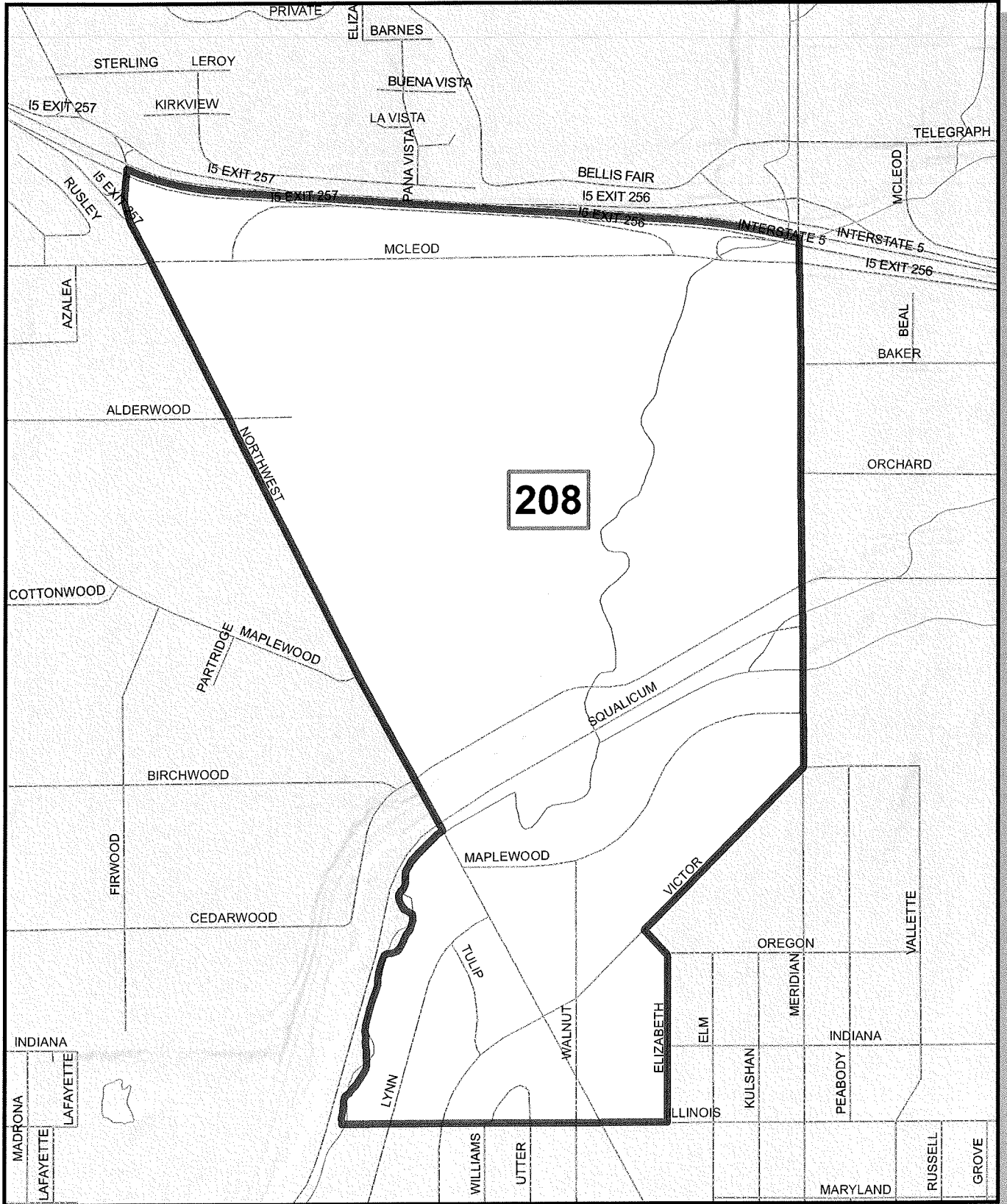

# Whatcom County Precinct 208

Ward 2  
 County Council District 2  
 Legislative District 42  
 Congressional District 2

USE OF WHATCOM COUNTY'S GIS DATA IMPLIES THE USER'S AGREEMENT WITH THE FOLLOWING STATEMENT:

Whatcom County disclaims any warranty of merchantability or warranty of fitness of this map for any particular purpose, or that accuracy is implied. No representation or warranty is made concerning the accuracy, currency, completeness or quality of data depicted on this map. Any user of this map assumes all responsibility for use thereof, and further agrees to hold Whatcom County harmless from and against any claims, loss, or liability arising from any use of this map.

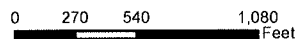



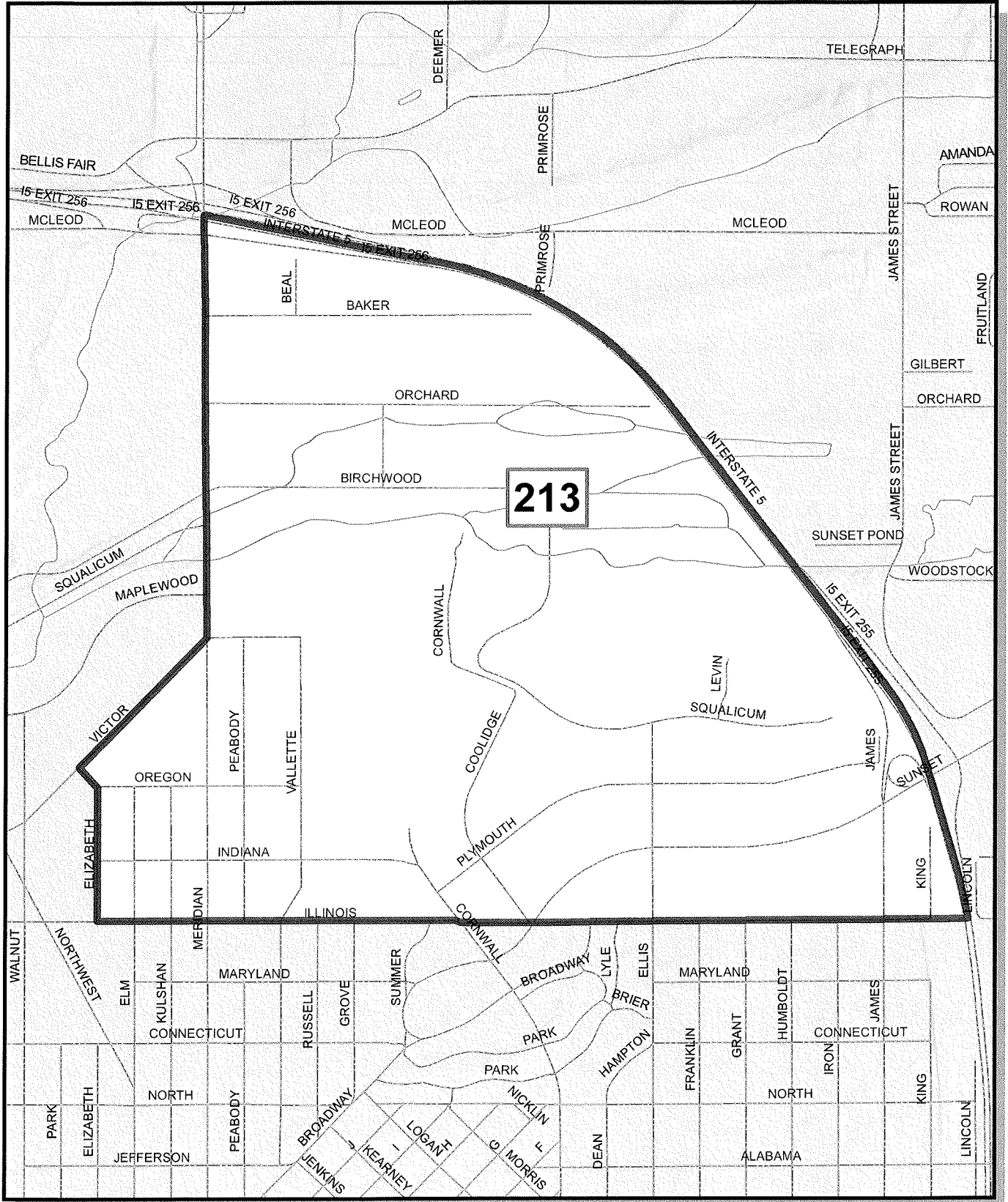

# Whatcom County Precinct 213

Ward 2  
 County Council District 2  
 Legislative District 42  
 Congressional District 2

USE OF WHATCOM COUNTY'S GIS DATA IMPLIES THE USER'S AGREEMENT WITH THE FOLLOWING STATEMENT:  
 Whatcom County disclaims any warranty of merchantability or warranty of fitness of this map for any particular purpose, or their express or implied. No representation or warranty is made concerning the accuracy, currency, completeness or quality of data depicted on this map. Any user of this map assumes all responsibility for use thereof, and further agrees to hold Whatcom County harmless from and against any damages, loss, or liability arising from any use of this map.

0 337.5 675 1,350 Feet





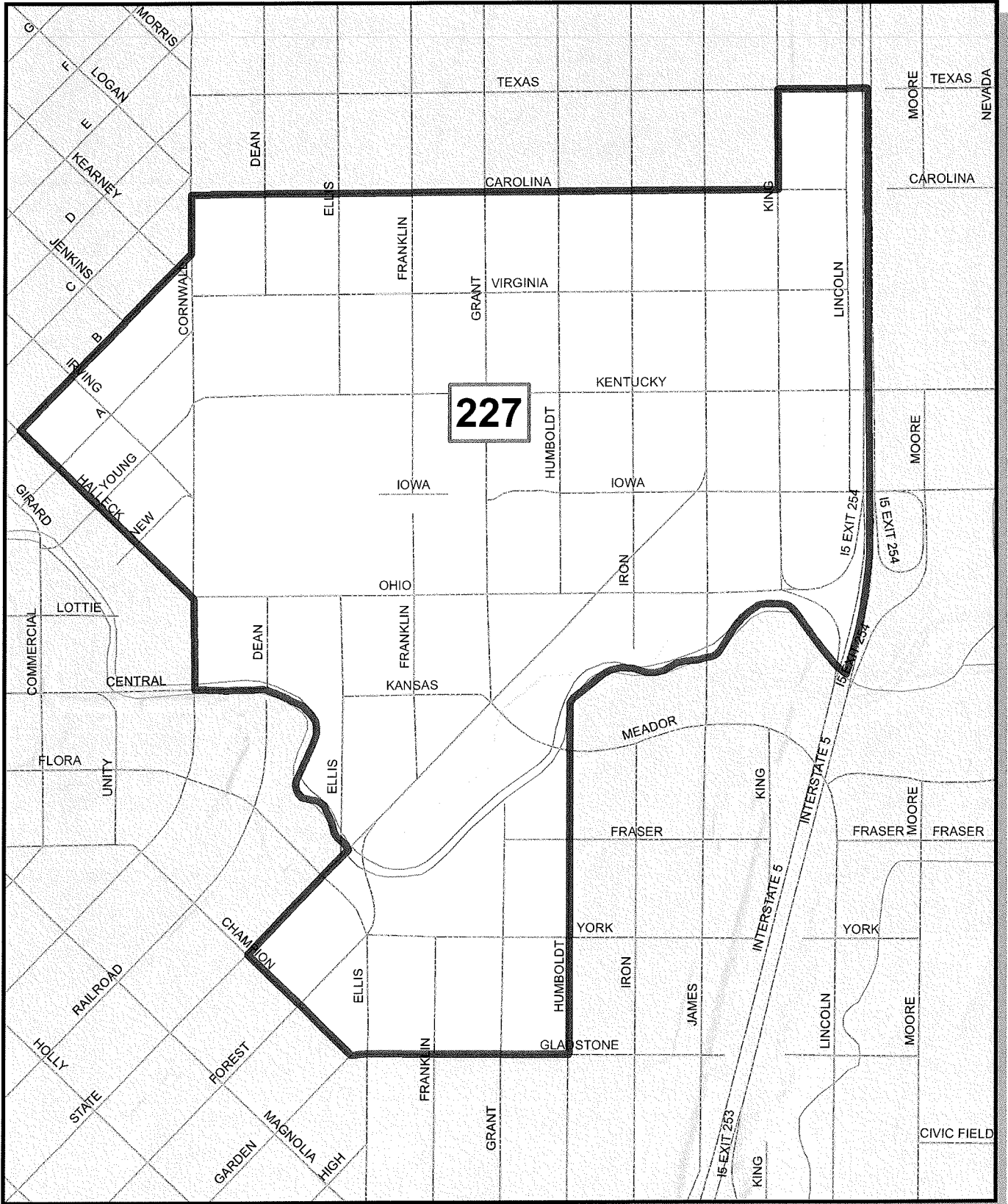

# Whatcom County Precinct 227

Ward 3  
 County Council District 1  
 Legislative District 42  
 Congressional District 2

USE OF WHATCOM COUNTY'S GIS DATA IMPLIES THE USER'S AGREEMENT WITH THE FOLLOWING STATEMENT:  
 Whatcom County disclaims any warranty of merchantability or warranty of fitness of this map for any particular purpose, or for any use not intended. No representation or warranty is made concerning the accuracy, currency, completeness or quality of data depicted on this map. Any user of this map does so at his/her own risk, and further agrees to hold Whatcom County harmless from and against any claims, losses, or liabilities arising from any use of this map.

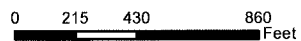

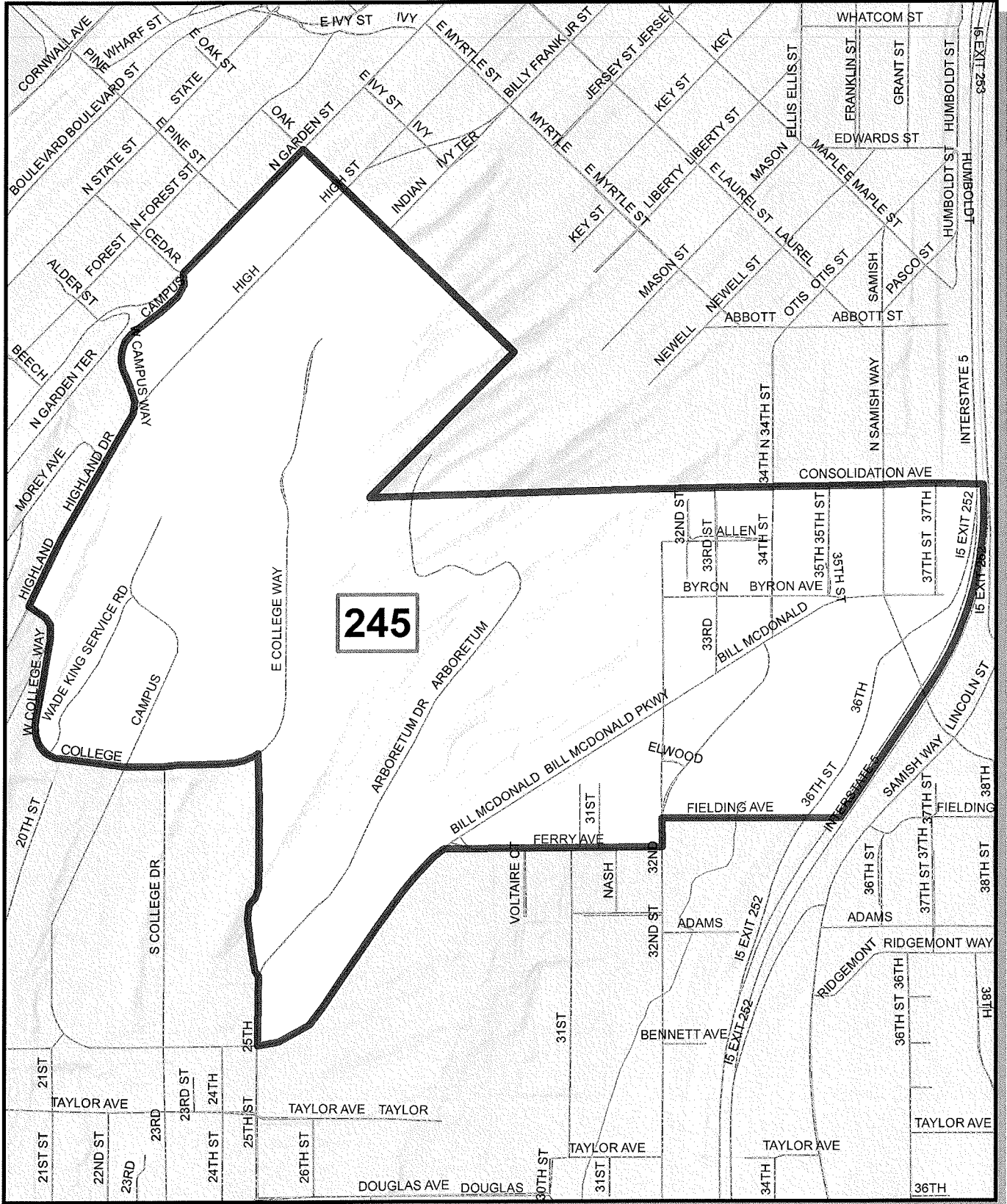

# Whatcom County Precinct 245

Ward 5  
 County Council District 1  
 Legislative District 40  
 Congressional District 2

USE OF WHATCOM COUNTY'S GIS DATA IMPLIES THE USER'S AGREEMENT WITH THE FOLLOWING STATEMENT:

Whatcom County disclaims any warranty of merchantability or warranty of fitness of the map for any particular purpose, in the express or implied. No representation or warranty is made concerning the accuracy, currency, completeness or quality of data depicted on this map. The user of this map assumes all responsibility for use thereof, and further agrees to hold Whatcom County harmless from and against any damage, loss, or liability arising from any use of this map.

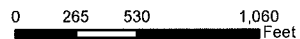

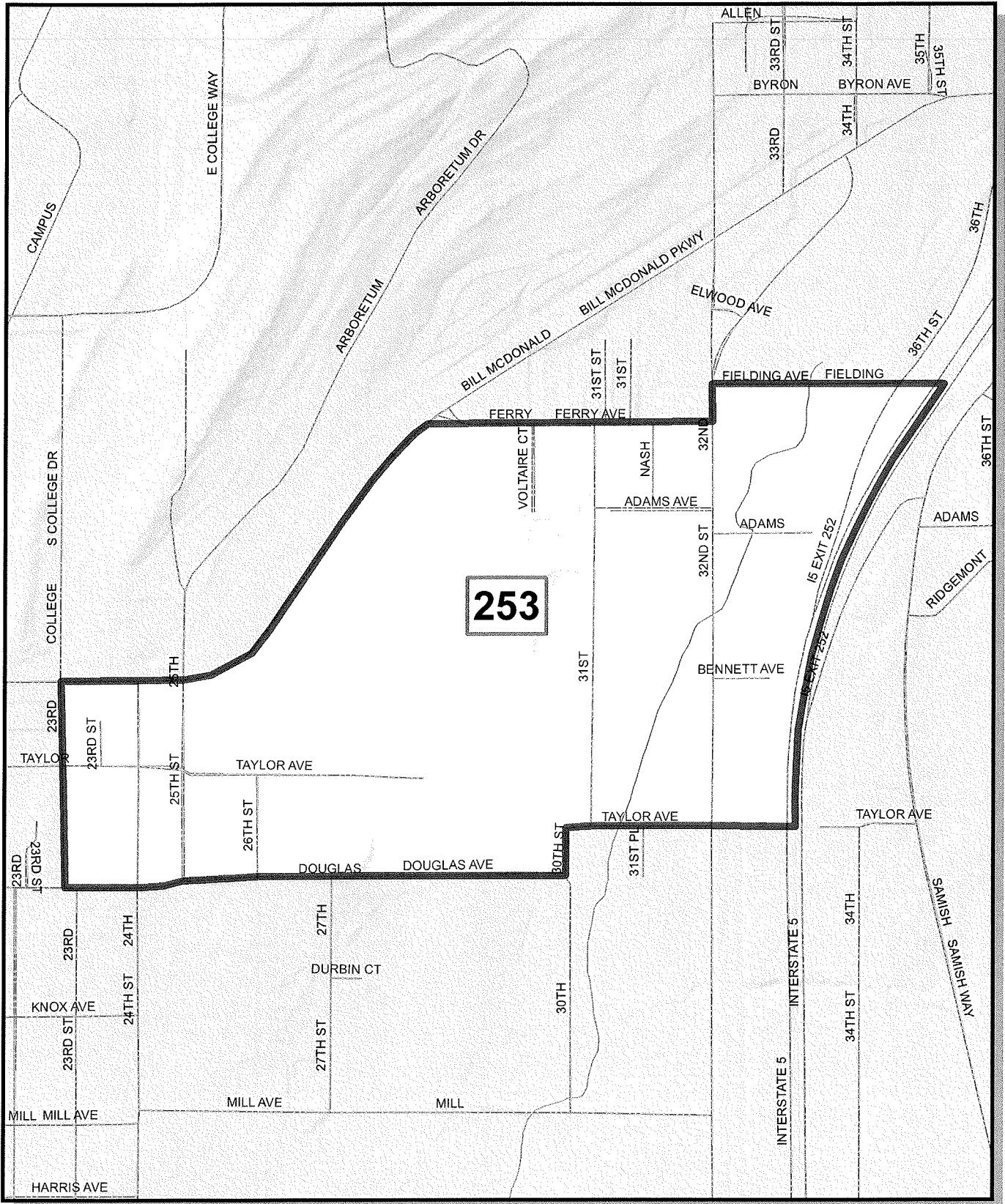

# Whatcom County Precinct 253

Ward 5  
 County Council District 1  
 Legislative District 40  
 Congressional District 2

USE OF WHATCOM COUNTY'S GIS DATA IMPLIES THE USER'S AGREEMENT WITH THE FOLLOWING STATEMENT:

Whatcom County disclaims any warranty of merchantability or warranty of fitness of this map for any particular purpose, either express or implied. No representation or warranty is made concerning the accuracy, currency, completeness or quality of data depicted on this map. Any user of this map assumes all responsibility for use thereof, and further agrees to hold Whatcom County harmless from and against any damage, loss, or liability within from any use of this map.

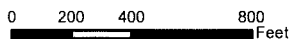



# Whatcom County Precinct 302

County Council District 5  
 Legislative District 42  
 Congressional District 1

USE OF WHATCOM COUNTY'S GIS DATA IMPLIES THE USER'S AGREEMENT WITH THE FOLLOWING STATEMENT:

Whatcom County disclaims any warranty of merchantability or warranty of fitness of this map for any particular purpose, either express or implied. No representation or warranty is made concerning the accuracy, currency, completeness or quality of data depicted on this map. Any user of this map assumes all responsibility for use thereof, and further agrees to hold Whatcom County harmless from and against any damages, loss, or liability arising from any use of this map.

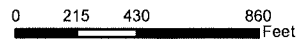



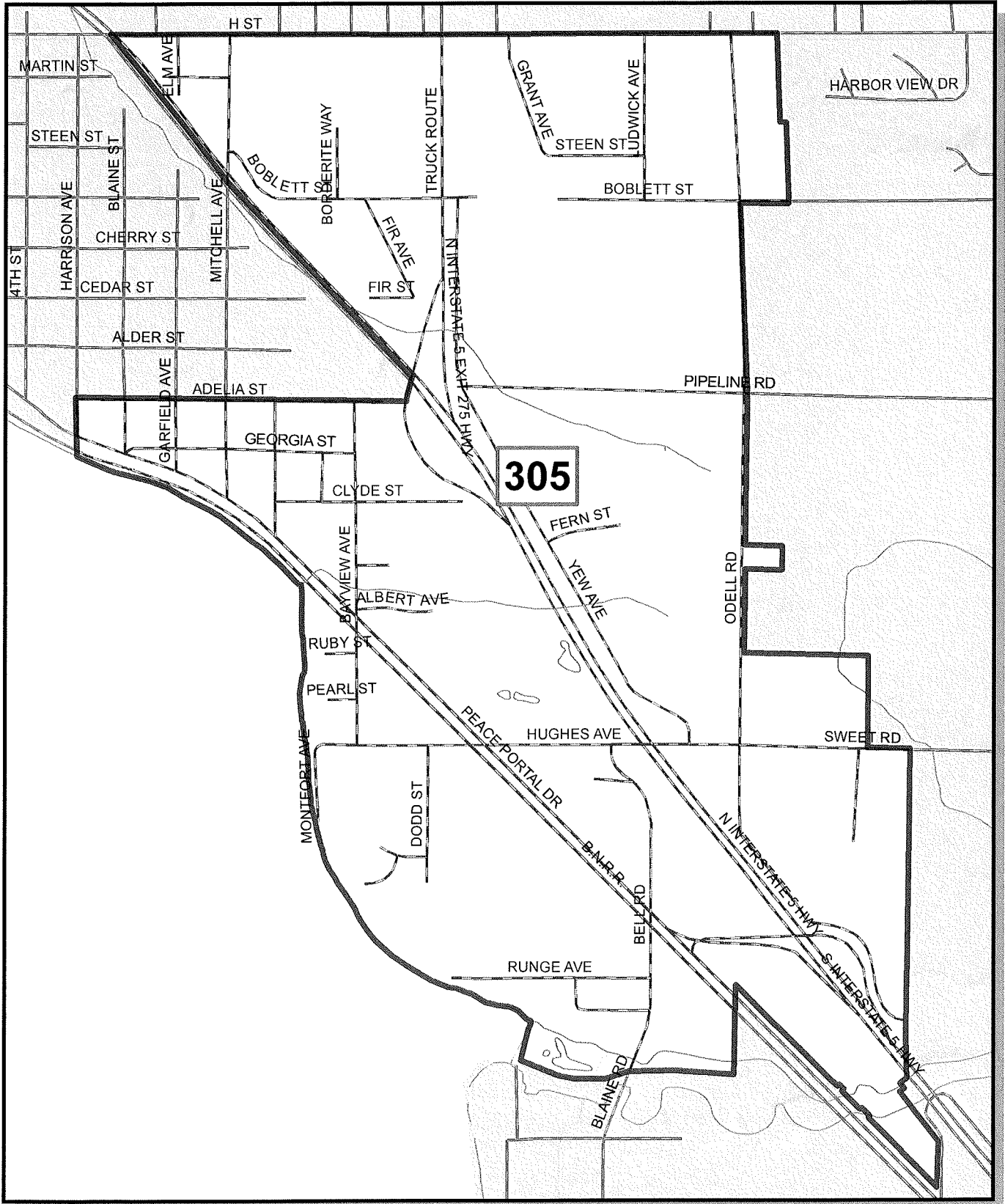

# Whatcom County Precinct 305

County Council District 5  
 Legislative District 42  
 Congressional District 1

USE OF WHATCOM COUNTY'S GIS DATA IMPLIES THE USER'S AGREEMENT WITH THE FOLLOWING STATEMENT:

Whatcom County disclaims any warranty of merchantability or warranty of fitness of this map for any particular purpose, either express or implied. No representation or warranty is made concerning the accuracy, currency, completeness or quality of data depicted on this map. Any user of this map assumes all responsibility for use thereof, and further agrees to hold Whatcom County harmless from and against any damages, loss, or liability arising from any use of this map.

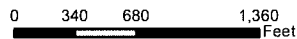

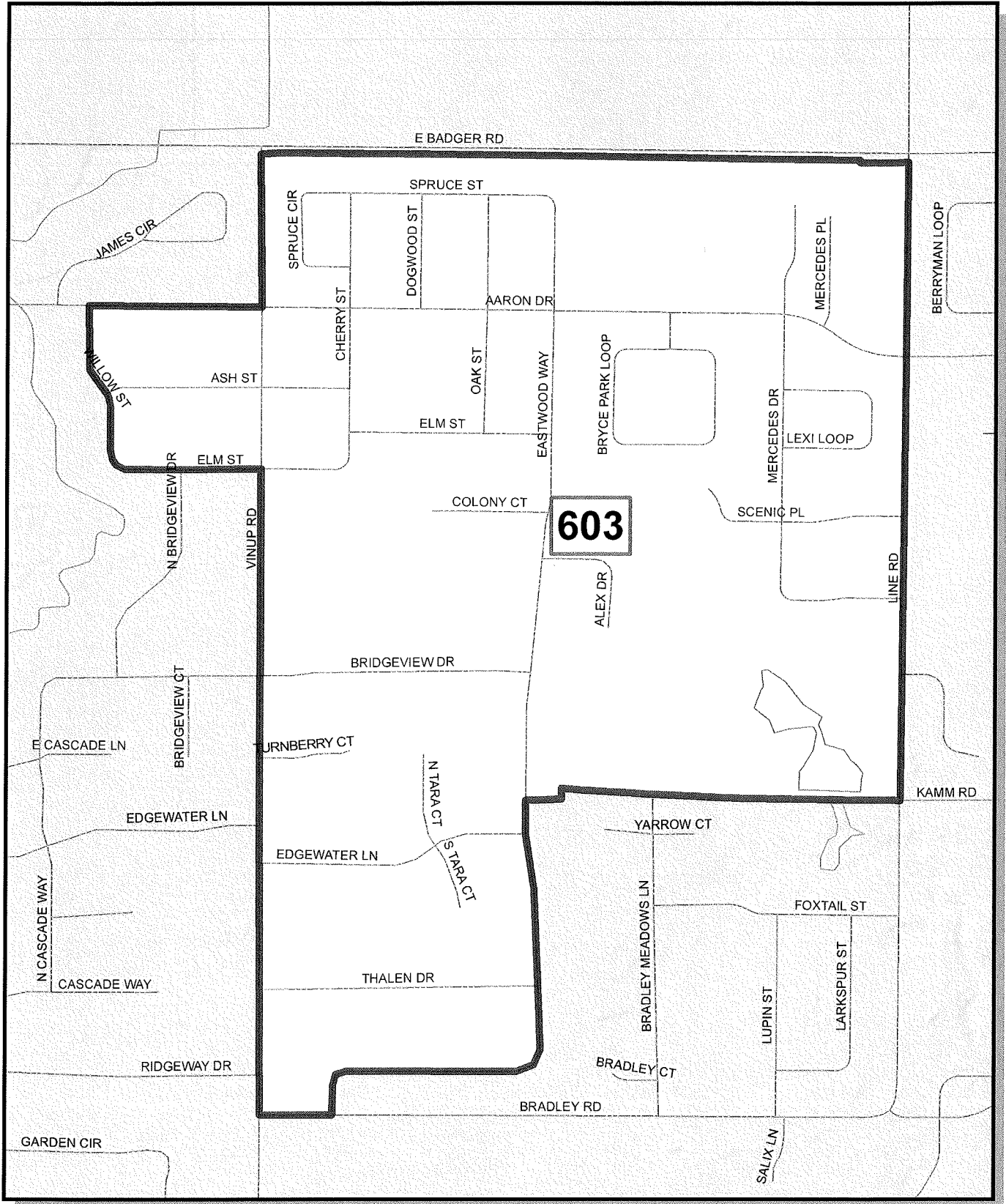

# Whatcom County Precinct 603

County Council District 4  
 Legislative District 42  
 Congressional District 1

USE OF WHATCOM COUNTY'S GIS DATA IMPLIES THE USER'S AGREEMENT WITH THE FOLLOWING STATEMENT:

Whatcom County disclaims any warranty of merchantability or warranty of fitness of this map for any particular purpose, either express or implied. No representation or warranty is made concerning the accuracy, currency, completeness or quality of data depicted on this map. Any user of this map assumes all responsibility for use thereof, and further agrees to hold Whatcom County harmless from and against any damage, loss, or liability arising from any use of this map.

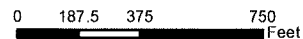



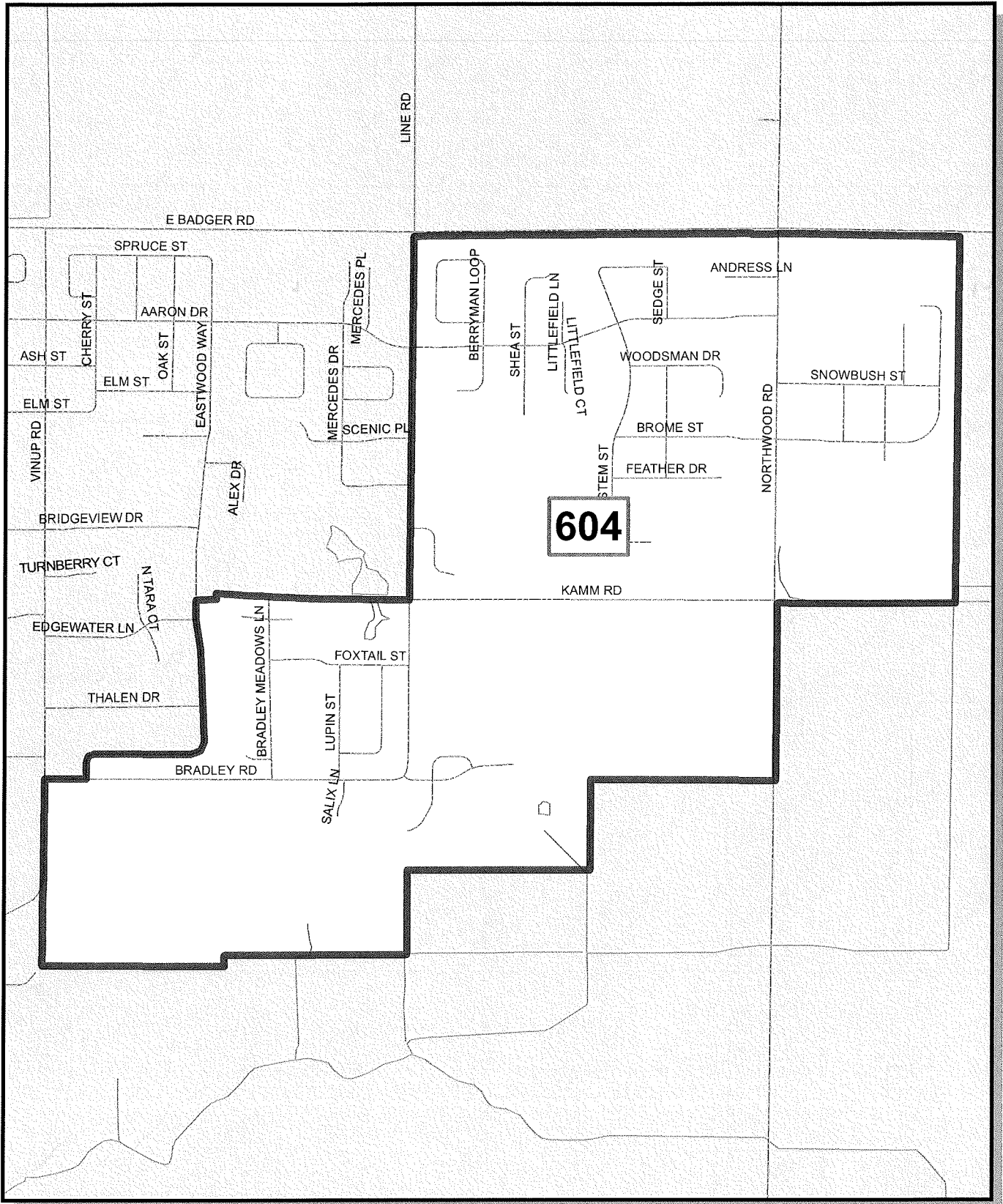

# Whatcom County Precinct 604

County Council District 4  
 Legislative District 42  
 Congressional District 1

USE OF WHATCOM COUNTY'S GIS DATA IMPLIES THE USER'S AGREEMENT WITH THE FOLLOWING STATEMENT:

Whatcom County disclaims any warranty of merchantability or warranty of fitness of this map for any particular purpose, with the exception of inland. No representation or warranty is made concerning the accuracy, currency, completeness or quality of data depicted on this map. Any user of this map assumes all responsibility for use of the map, and further agrees to hold Whatcom County harmless from and against any damage, loss, or liability arising from any use of this map.

