



## **MEMORANDUM**

**TO:** Satpal Sidhu, County Executive

**FROM:** Bennett Knox, Director 

**RE:** Replacement Access Easement for 3303 North Shore (access through Lake Whatcom Park)

**DATE:** February 25, 2025

---

Please find for an attached access easement as well as a companion easement relinquishment associated with a property adjacent to Lake Whatcom Park.

### **Background and Purpose**

Private property at 3303 North Shore Road (Hall Property) benefits from an easement (executed in January 1991 and recorded as Auditor's File No. 910110133) over a portion of Lake Whatcom Park for purpose of ingress and egress along a driveway to/from the residence (see Exhibit A).

The current easement had an initial term of 35 years and is expiring in early 2026. Legally such an easement is perpetual in nature and appurtenant to the property. Upon advice of the prosecuting attorney the current easement should be relinquished and replaced with a new document that runs with the land.

Attached is an easement relinquish document to relinquish the existing easement (File No. 910110133) and a new easement which is perpetual and appurtenant to the Hall property.

### **Recommendation**

Approval and signature for both the new access easement and relinquishment of the current easement.

### **Funding Amount and Source**

Payment of \$650 is required from the grantee for document recording.



# Exhibit A

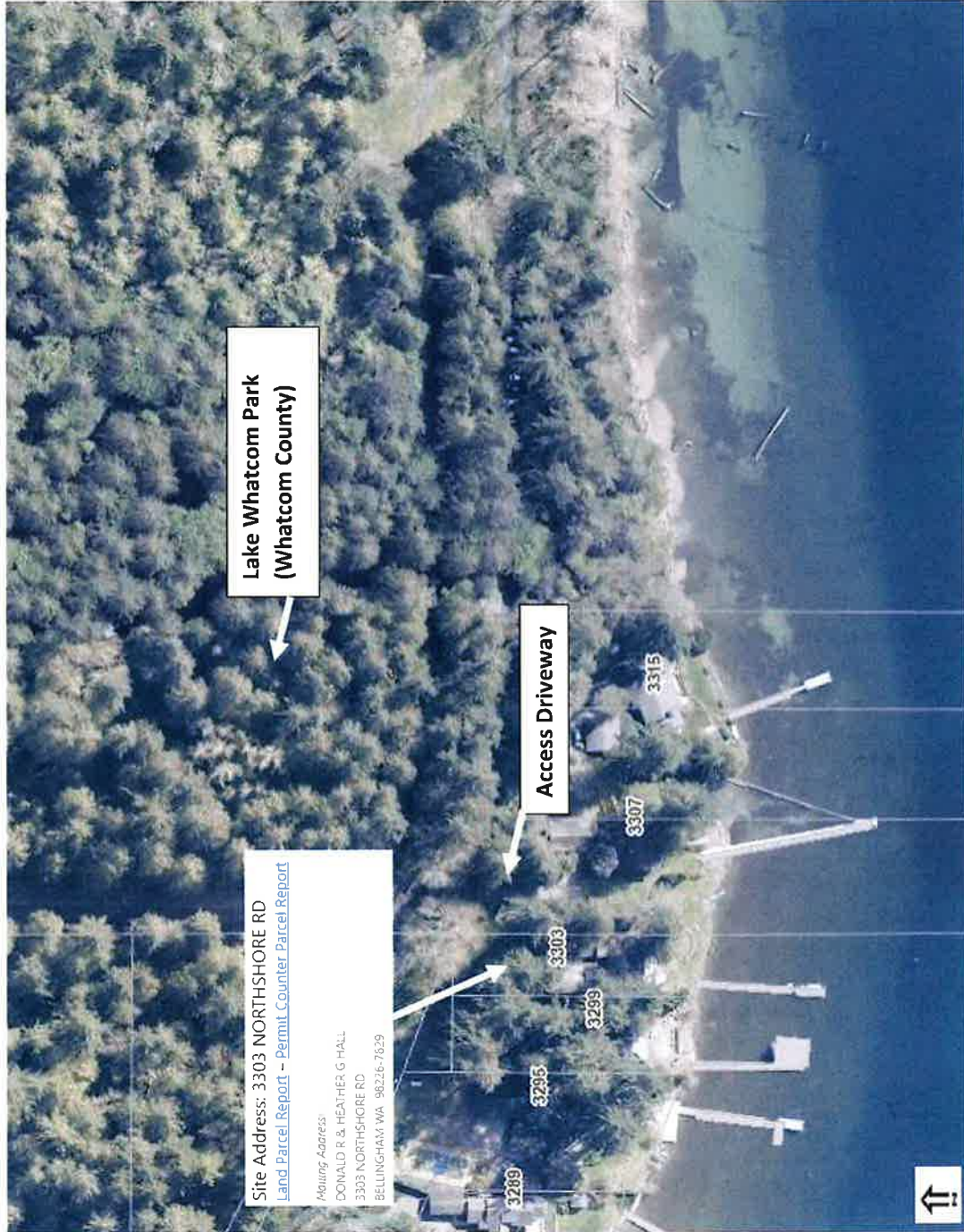

Site Address: 3303 NORTSHORE RD  
 Land Parcel Report - Permit Counter Parcel Report

Mailing Address  
 DONALD R. & HEATHER G HALL  
 3303 NORTSHORE RD  
 BELLINGHAM, WA 98226-7829

Lake Whatcom Park  
 (Whatcom County)

Access Driveway

248 0 124 248 Feet

The City of Bellingham has compiled this information for its own use and is not responsible for any use of this information by others. This information is provided simply as a courtesy to the public and is not intended for any and every use in any official, professional or other authoritative capacity. Persons using this information do so at their own risk and by such use agree to defend, indemnify and hold harmless the City of Bellingham as to any claims, damages, liability, losses or suits arising out of such use. Contact the Whatcom County Assessors office (360-778-5050) for the most up to date parcel information.

THIS MAP IS NOT TO BE USED FOR NAVIGATION



## Legend

- Buildings
- Docks
- Tax Parcels
- Care Facility
- Hospital
- Schools
- <all other values>
- Schools
- Colleges/Universities
- Elementary, Middle, High Schools
- Private School or Preschool
- Five Stations
- City Boundary
- Urban Growth Area
- Trails
- Railroads
- Ferries
- Residential Street
- Interstate
- Airport
- Open Channel Streams
- Parks

## Notes

Printed 1/20/2025 4:09:19 PM