

APPLICATION FOR FRANCHISE

TO THE WHATCOM COUNTY COUNCIL:

COMES NOW, The City of Lynden, Washington

who respectfully petitions the Whatcom County Council for a twenty-five (25) year franchise to lay, construct, maintain, and repair

An industrial condensate pipeline

and all necessary appurtenances along, over, and across the following roads situated in Whatcom County, Washington:

The section of Hannegan Road between the Nooksack River and Riverview Road in
Section 20 of Township 40 North, Range 3 East, WM. A detailed explanation is
attached as EXHIBIT A and a sketch is attached as EXHIBIT B hereto.

The petitioner further requests that the Whatcom County Council fix a time and place for a public hearing on the granting of this continuation of franchise, and that public notice be given, at the expense of the petitioner, as provided by law; and that, at said hearing, petitioner be granted the franchise continuation herein requested.

DATED: 01/28/2020

City of Lynden, Public Works Department
Company Name

300 4th Street
Mailing Address

Lynden, WA 98264
City State Zip

(360) 354-3446
Phone Number

Signature of authorized agent/owner

Scott Kortheis
Print or type name

EXHIBIT A

Description of Industrial Condensate Pipeline

The industrial condensate pipeline (ICP) runs north-south from the Nooksack River, along Hannegan Road, to Riverview Road. Starting at the Nooksack River and running north-south along Hannegan Road, the ICP consist of 53 feet of 18" HDPE pipe, 190 feet of 18" PVC pipe, a 60" manhole, and a 48" manhole that is partially in the right-of-way. At that point, the ICP crosses Hannegan Road with 85 feet of 18" PVC pipe within 85 feet of a 30" DI boring casing before going onto private property on the west side of the Hannegan Road. Approximately 180 feet further north, the ICP runs north-south within the right-of-way, and consists of 400 feet of 18" PVC pipe, 1020 feet of 12" CIPP lined pipe, and 5 48" manholes, before the ICP runs onto private property to the west. Overall, the ICP will have 53 feet of 18" HDPE pipe, 675 feet of 18" PVC pipe, 1020 feet of 12" CIPP lined pipe, 85 feet of 30" DI boring casing pipe, 1 60" manhole, and 6 48" manhole with the county right-of-way. All pipe will be underground, and the manholes will be partially above ground (flush with grade).

EXHIBIT B

Sketches

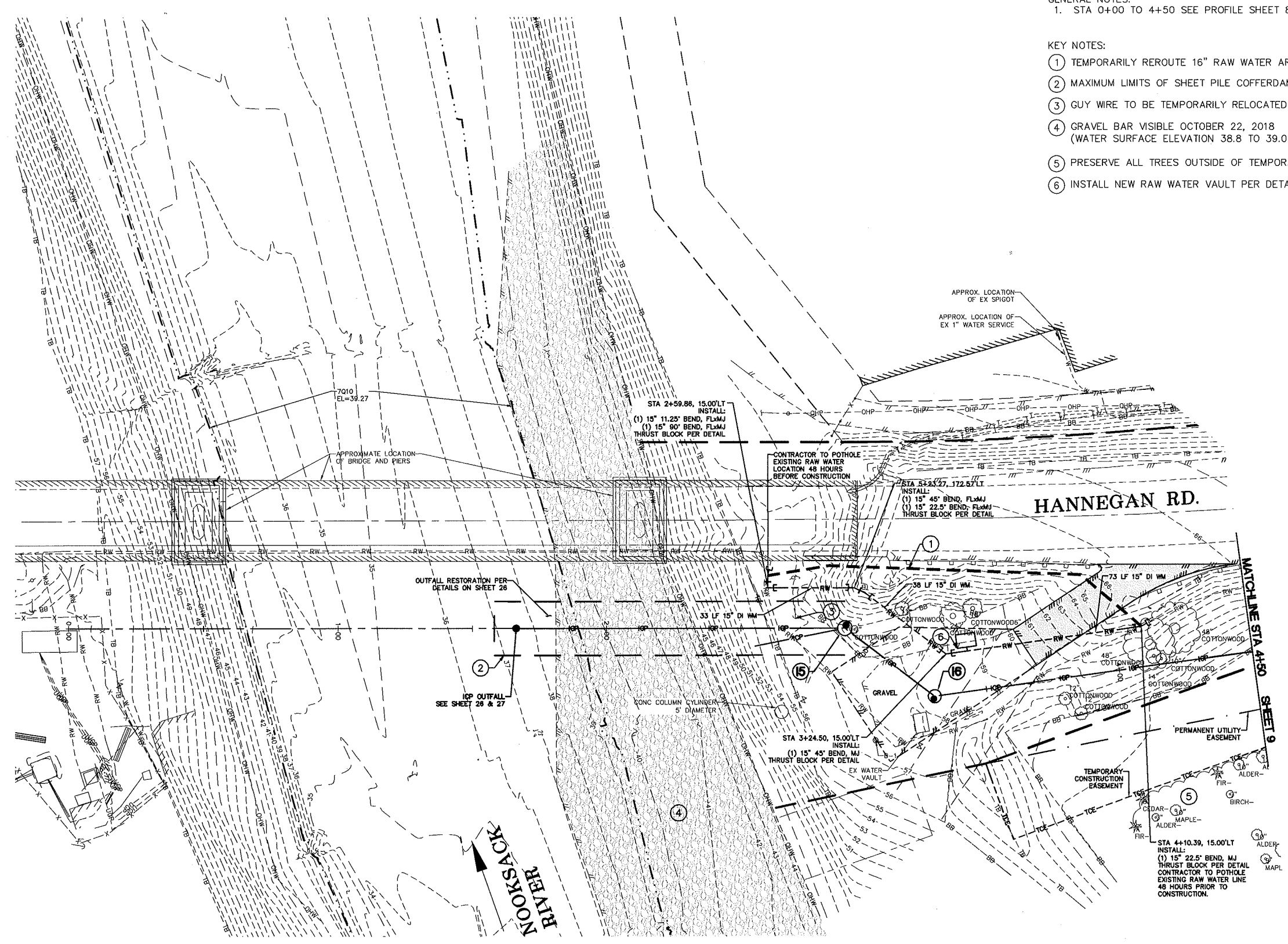
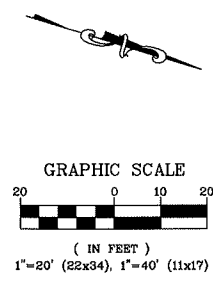

GENERAL NOTES:
 1. STA 0+00 TO 4+50 SEE PROFILE SHEET 8.

- KEY NOTES:
- ① TEMPORARILY REROUTE 16" RAW WATER AROUND EXCAVATION.
 - ② MAXIMUM LIMITS OF SHEET PILE COFFERDAM. SEE SHEET 26.
 - ③ GUY WIRE TO BE TEMPORARILY RELOCATED BY OTHERS.
 - ④ GRAVEL BAR VISIBLE OCTOBER 22, 2018 (WATER SURFACE ELEVATION 38.8 TO 39.0 FEET)
 - ⑤ PRESERVE ALL TREES OUTSIDE OF TEMPORARY CONSTRUCTION EASEMENT.
 - ⑥ INSTALL NEW RAW WATER VAULT PER DETAIL ON SHEET ____.



Brown and Caldwell

DESIGNED BY
OAM
 DRAWN BY
OAM/LMH
 CHECKED BY
IDH/NZ

R&E Reichhardt & Ebe ENGINEERING INC
 P.O. Box 978 | 423 Front Street
 Lynden, WA 98264 (360) 354-3687

NO.	DATE	DESCRIPTION	BY

CITY OF LYNDEN
 300 4TH ST.
 LYNDEN, WA 98264

CITY OF LYNDEN
 INDUSTRIAL CONDENSATE PIPELINE
 PLAN - STA 0+00 TO 4+50

DWG 16001 ICP	DATE 11/8/19
JOB# 16001	SHEET 7 of 27
SCALE H: 1"=20' v: N/A	

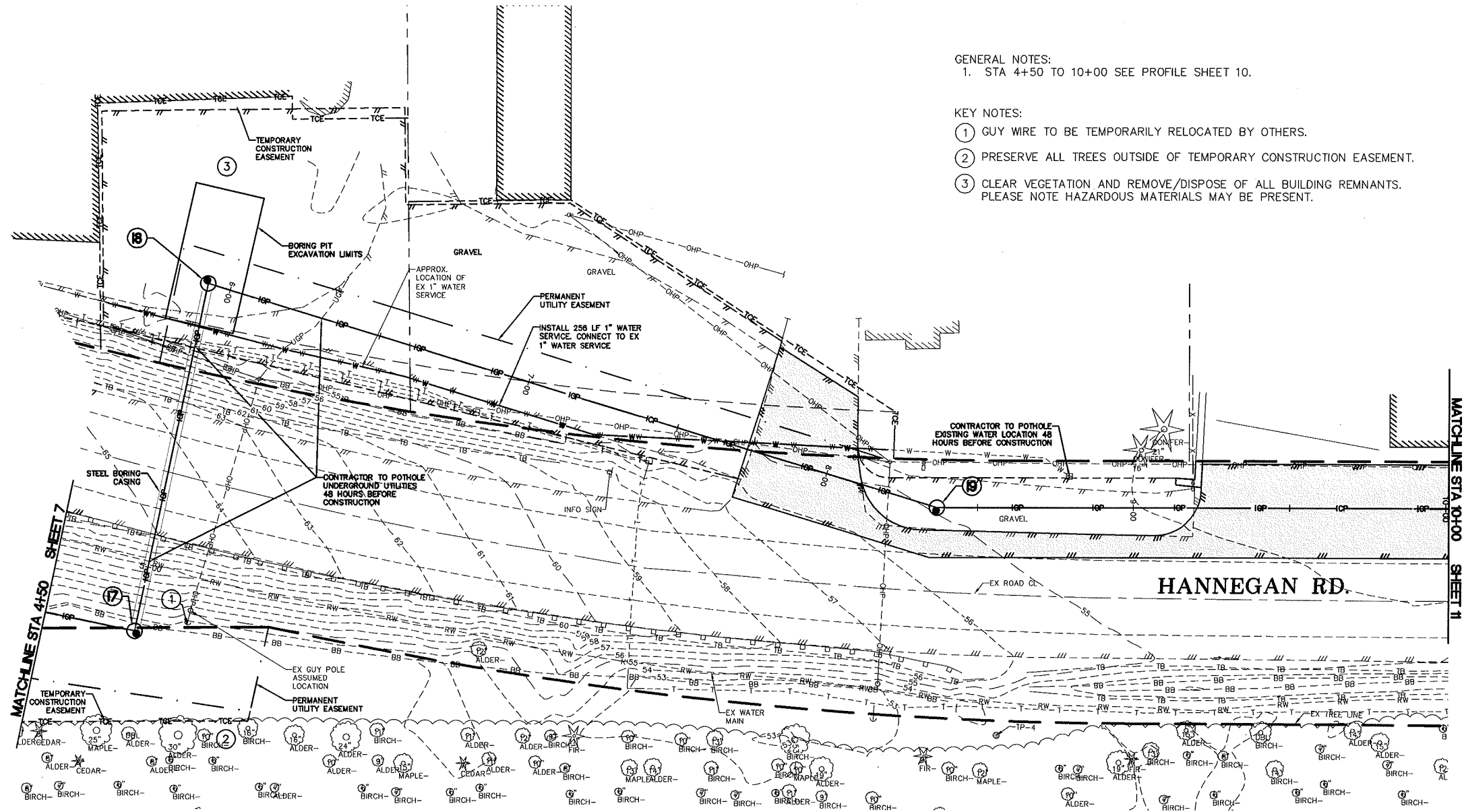
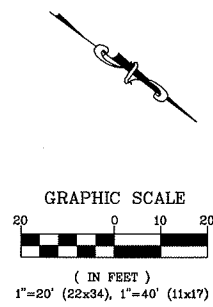

GENERAL NOTES:
 1. STA 4+50 TO 10+00 SEE PROFILE SHEET 10.

- KEY NOTES:
 ① GUY WIRE TO BE TEMPORARILY RELOCATED BY OTHERS.
 ② PRESERVE ALL TREES OUTSIDE OF TEMPORARY CONSTRUCTION EASEMENT.
 ③ CLEAR VEGETATION AND REMOVE/DISPOSE OF ALL BUILDING REMNANTS. PLEASE NOTE HAZARDOUS MATERIALS MAY BE PRESENT.

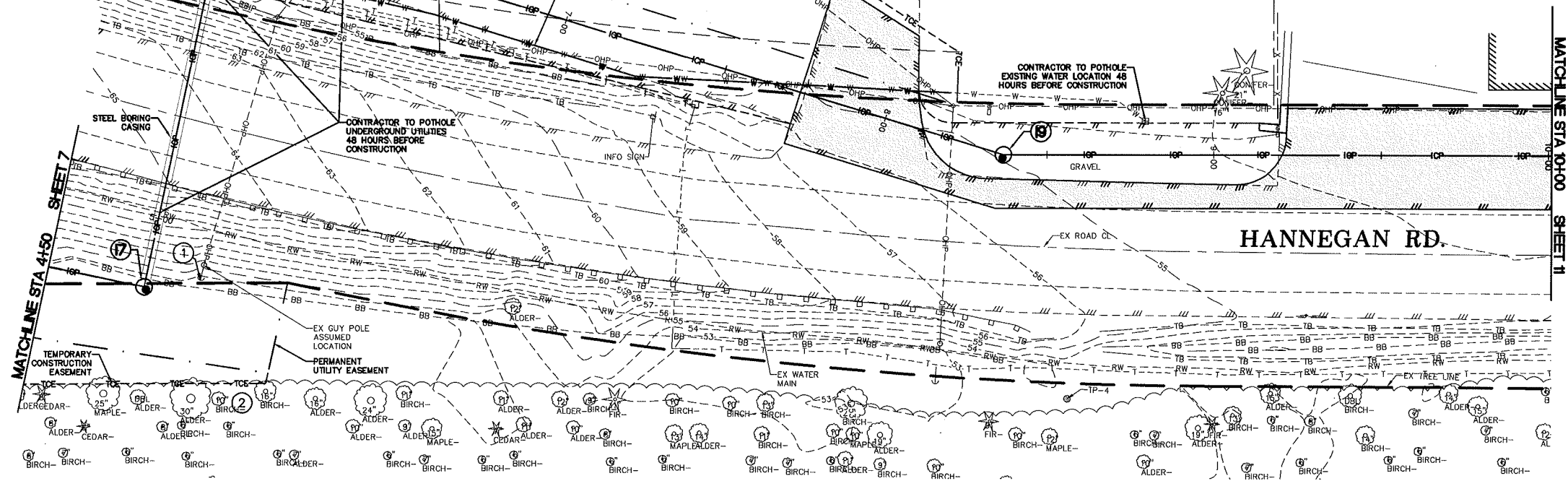

PRELIMINARY

DESIGNED BY
OAM
 DRAWN BY
OAM/LMH
 CHECKED BY
IDH/NZ

R&E Reichhardt & Ebe
 ENGINEERING INC
 P.O. Box 978 | 423 Front Street
 Lynden, WA 98264 (360) 354-3687

NO.	DATE	DESCRIPTION	BY

CITY OF LYNDEN
 300 4TH ST.
 LYNDEN, WA 98264

CITY OF LYNDEN
 INDUSTRIAL CONDENSATE PIPELINE
 PLAN - STA 4+50 TO 10+00

DWG 16001 ICP	DATE 11/8/19
JOB# 16001	SHEET 9 of 27
SCALE H: 1"=20' v: N/A	

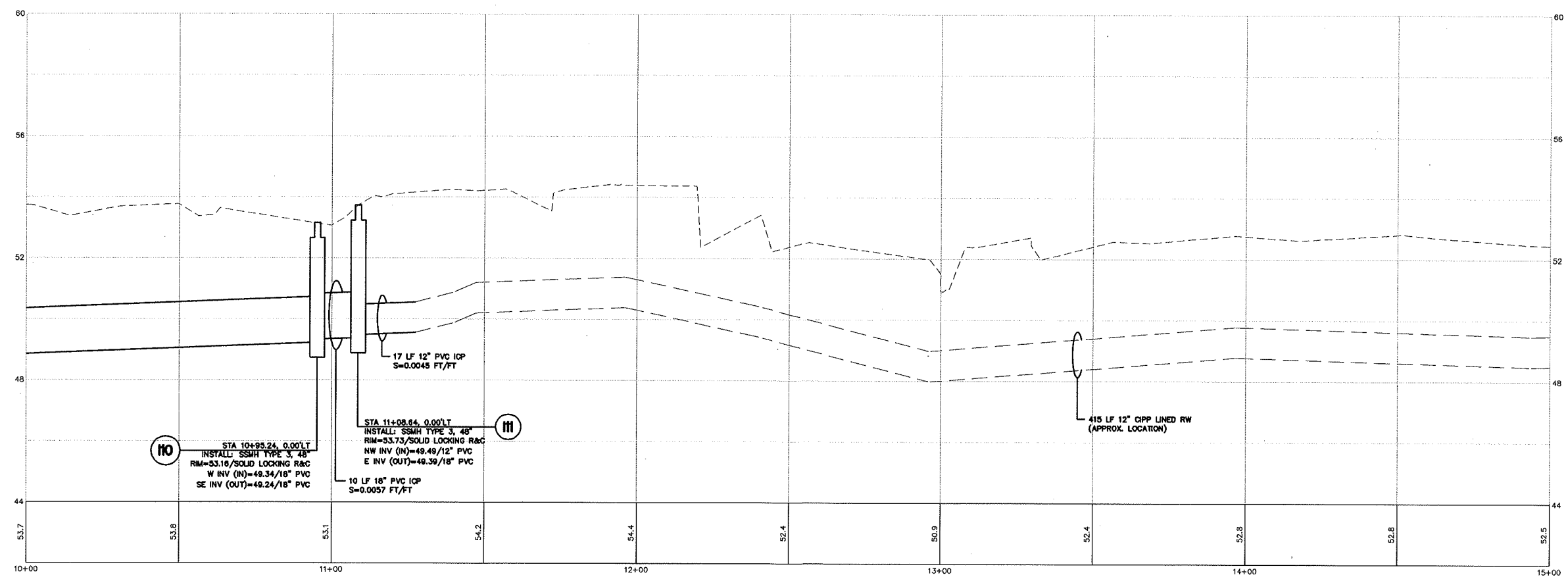
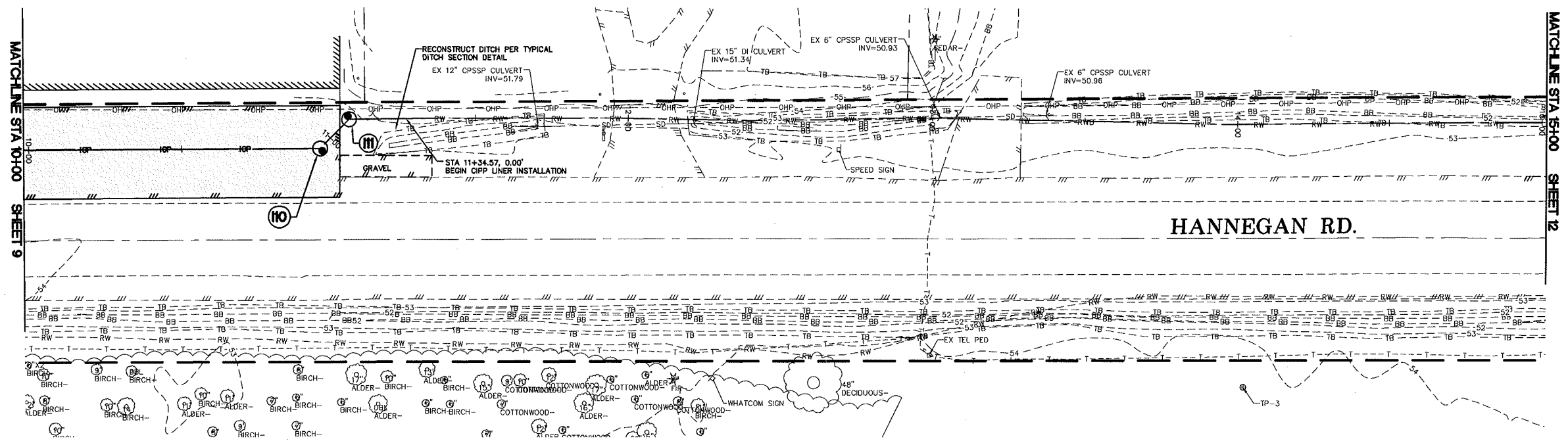

PRELIMINARY

DESIGNED BY
OAM
DRAWN BY
OAM/LMH
CHECKED BY
IDH/NZ

R&E Reichardt & Ebe
ENGINEERING INC
P.O. Box 978 | 423 Front Street
Lynden, WA 98264 (360) 354-3687

NO.	DATE	DESCRIPTION	BY

CITY OF LYNDEN
300 4TH ST.
LYNDEN, WA 98264

CITY OF LYNDEN
INDUSTRIAL CONDENSATE PIPELINE
PLAN AND PROFILE - STA 10+00 TO 15+00

DWG 16001 ICP

JOB# 16001

SCALE
H: 1"=20' V: 1"=2'

DATE 11/8/19
SHEET 11 of 27



P:\Projects\16001\16001 ICP.dwg 11 PLAN AND PROFILE, STA 10+00 TO 15+00, 11/8/2019 2:15:52 PM, PLOT: 16001 ICP.dwg

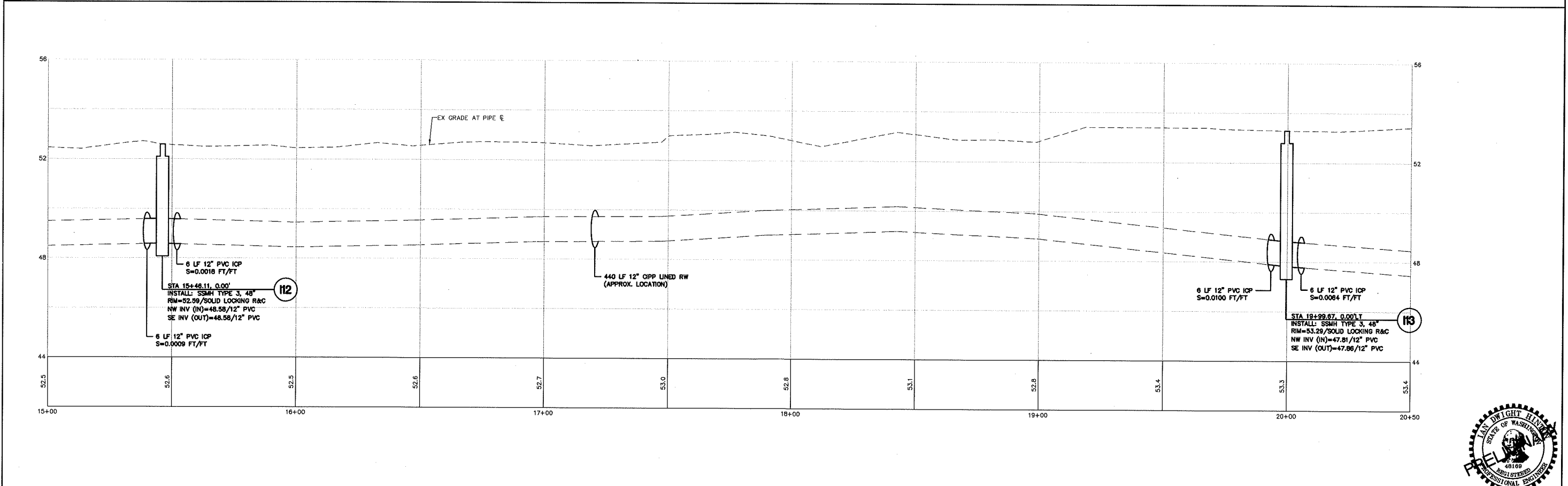
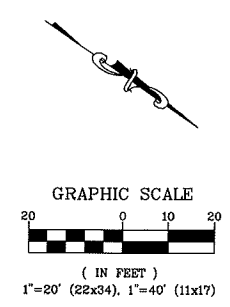
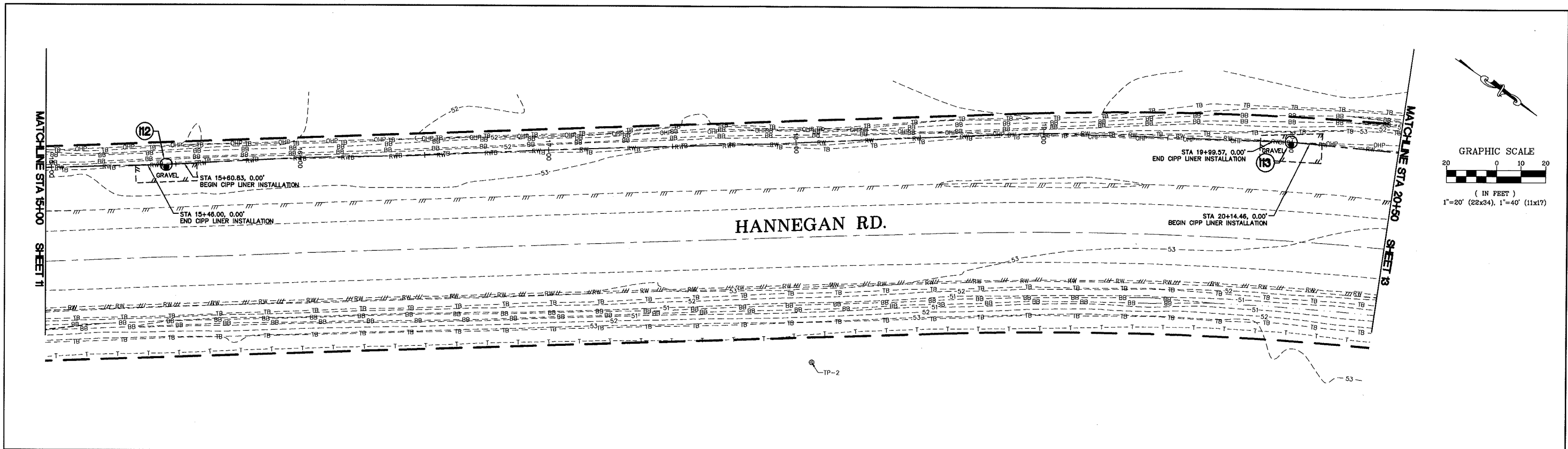

PRELIMINARY	DESIGNED BY OAM	R&E Reichhardt & Ebe ENGINEERING INC P.O. Box 978 423 Front Street Lynden, WA 98264 (360) 354-3687	NO.	DATE	DESCRIPTION	BY	CITY OF LYNDEN 300 4TH ST. LYNDEN, WA 98264	CITY OF LYNDEN INDUSTRIAL CONDENSATE PIPELINE PLAN AND PROFILE - STA 15+00 TO 20+50	DWG# 16001 ICP	DATE 11/8/19
	DRAWN BY OAM/LMH		CHECKED BY IDH/NZ							JOB# 16001

P:\Projects\16001 ICP - 2019\16001 ICP - PLAN AND PROFILE - STA 15+00 TO 20+50.dwg, 11/8/2019 2:18:07 PM, PLOT: 20x34

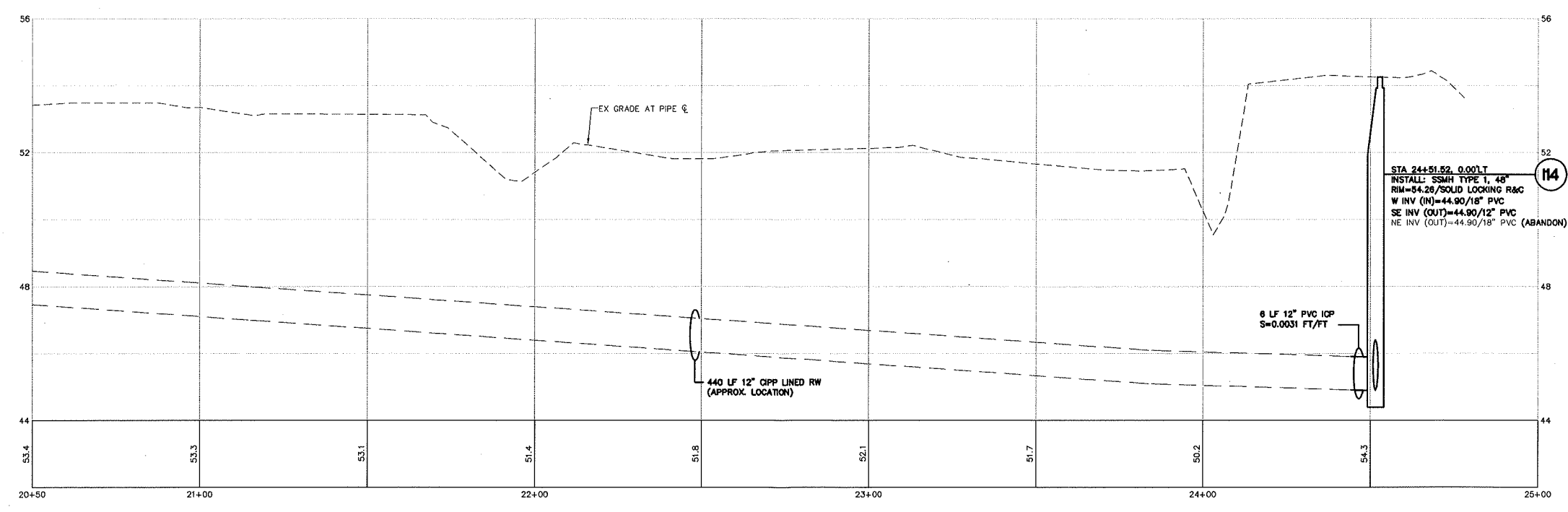
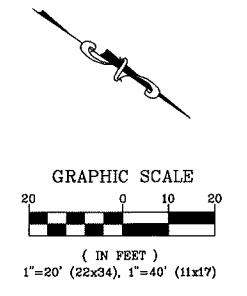
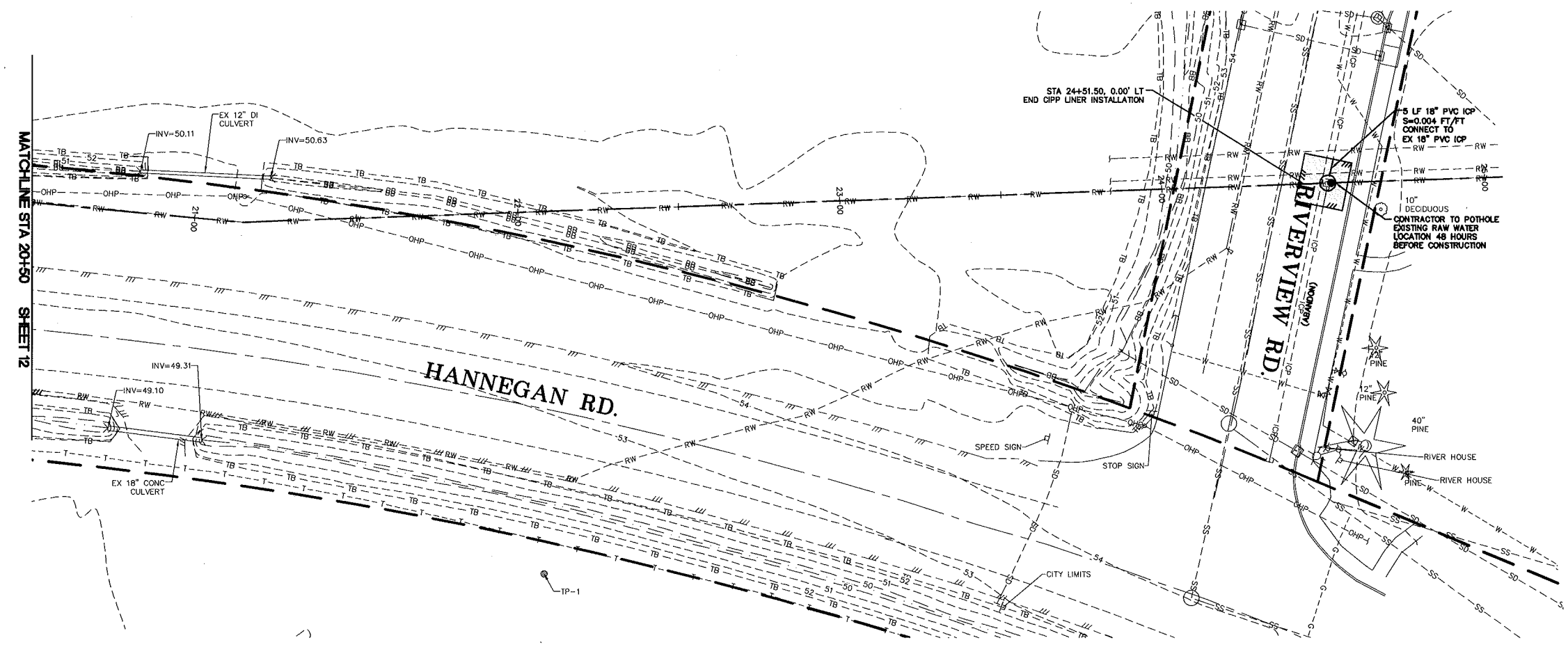

STA 24+51.52, 0.00' LT
 INSTALL: SSMH TYPE 1, 48"
 RIM=54.28/SOLID LOCKING R&C
 W INV (IN)=44.90/18" PVC
 SE INV (OUT)=44.90/12" PVC
 NE INV (OUT)=44.90/18" PVC (ABANDON)



PRELIMINARY

DESIGNED BY OAM
 DRAWN BY OAM/LMH
 CHECKED BY IDH/NZ
R&E Reichhardt & Ebe ENGINEERING INC
 P.O. Box 978 | 423 Front Street
 Lynden, WA 98264 (360) 354-3687

NO.	DATE	DESCRIPTION	BY

CITY OF LYNDEN
 300 4TH ST.
 LYNDEN, WA 98264

CITY OF LYNDEN
 INDUSTRIAL CONDENSATE PIPELINE
 PLAN AND PROFILE - STA 20+50 TO 25+00

DWG 16001 ICP	DATE 11/8/19
JOB# 16001	SHEET 13 of 27
SCALE H: 1"=20' V: 1"=2'	