



Whatcom County

COUNTY COURTHOUSE
311 Grand Avenue, Ste #105
Bellingham, WA 98225-4038
(360) 778-5010

Agenda Bill Master Report

File Number: AB2019-495

File ID:	AB2019-495	Version:	1	Status:	Adopted
File Created:	09/23/2019	Entered by:	RMcconne@co.whatcom.wa.us		
Department:	Public Works Department	File Type:	Ordinance Requiring a Public Hearing		
Assigned to:	Council	Final Action:	10/22/2019		
Agenda Date:	10/22/2019	Enactment #:	ORD 2019-072		

Primary Contact Email: sdraper@co.whatcom.wa.us

TITLE FOR AGENDA ITEM:

Ordinance reauthorizing a Golf Cart Zone on certain roads in the Birch Bay Area

SUMMARY STATEMENT OR LEGAL NOTICE LANGUAGE:

See attached memo

HISTORY OF LEGISLATIVE FILE

Date:	Acting Body:	Action:	Sent To:
10/08/2019	Council	INTRODUCED FOR PUBLIC HEARING	Council
		Aye: 7 Brenner, Browne, Buchanan, Byrd, Donovan, Frazey, and Sidhu	
		Nay: 0	
		Absent: 0	
10/22/2019	Council	ADOPTED	
		Aye: 7 Brenner, Browne, Buchanan, Byrd, Donovan, Frazey, and Sidhu	
		Nay: 0	
		Absent: 0	

ORDINANCE NO. 2019-072

REAUTHORIZING A GOLF CART ZONE ON CERTAIN ROADS IN THE BIRCH BAY AREA

WHEREAS, Birch Bay area residents have requested to operate golf carts in the Birch Bay area; and

WHEREAS, RCW 46.08.175 allows for the creation of golf cart zones; and

WHEREAS, the Birch Bay Chamber of Commerce supports the reauthorization of a golf cart zone in the Birch Bay area; and

WHEREAS, the speed limit on all of the roads in the proposed Golf Cart Zone are 25 MPH or less; and

WHEREAS, the operators of golf carts shall be licensed motor vehicle operators as required by RCW 46.20.001.

NOW, THEREFORE, BE IT ORDAINED by the Whatcom County Council that a Golf Cart Zone is hereby established on Birch Bay Drive and all county roads posted 25 MPH or less that lead to, and are contiguous with, Birch Bay Drive;

BE IT FURTHER ORDAINED, that the County Engineer is hereby directed to install the appropriate signs and the Whatcom County Sheriff and the Washington State Patrol be notified by a copy of this ordinance.

ADOPTED this 22nd day of October, 2019.

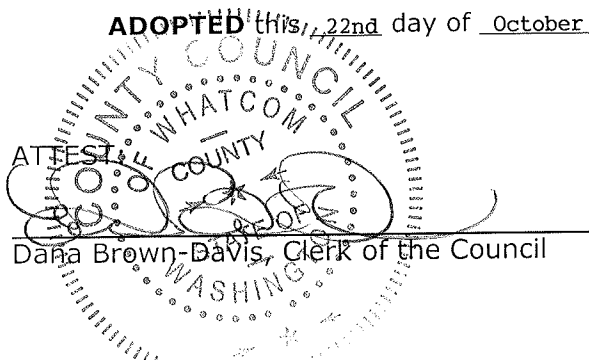
ATTEST:

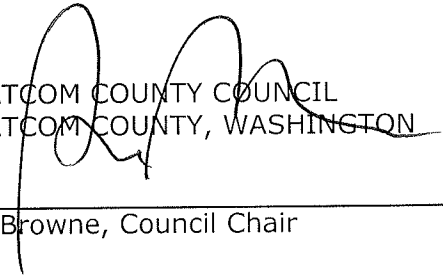
Dana Brown-Davis, Clerk of the Council

WHATCOM COUNTY COUNCIL
WHATCOM COUNTY, WASHINGTON

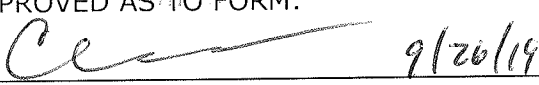
Rud Browne, Council Chair

APPROVED AS TO FORM:
 9/26/19

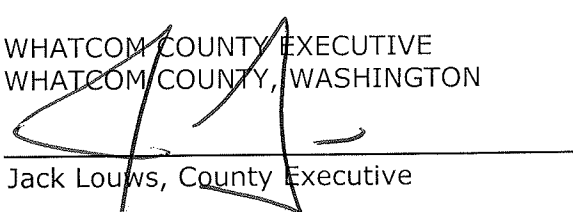
Christopher Quinn,
Civil Deputy Prosecutor

WHATCOM COUNTY EXECUTIVE
WHATCOM COUNTY, WASHINGTON

Jack Louws, County Executive
 Approved Denied
Date Signed: 10/23/19



ATTACHMENT "A"

DEPARTMENT OF PUBLIC WORKS
322 N. COMMERCIAL ST., SUITE 301
BELLINGHAM, WA 98225
(360) 778-6219

SITUATE IN A PORTION OF SECTION 24
TOWNSHIP 40 NORTH, RANGE 1 WEST, W.M.
WHATCOM COUNTY, WASHINGTON

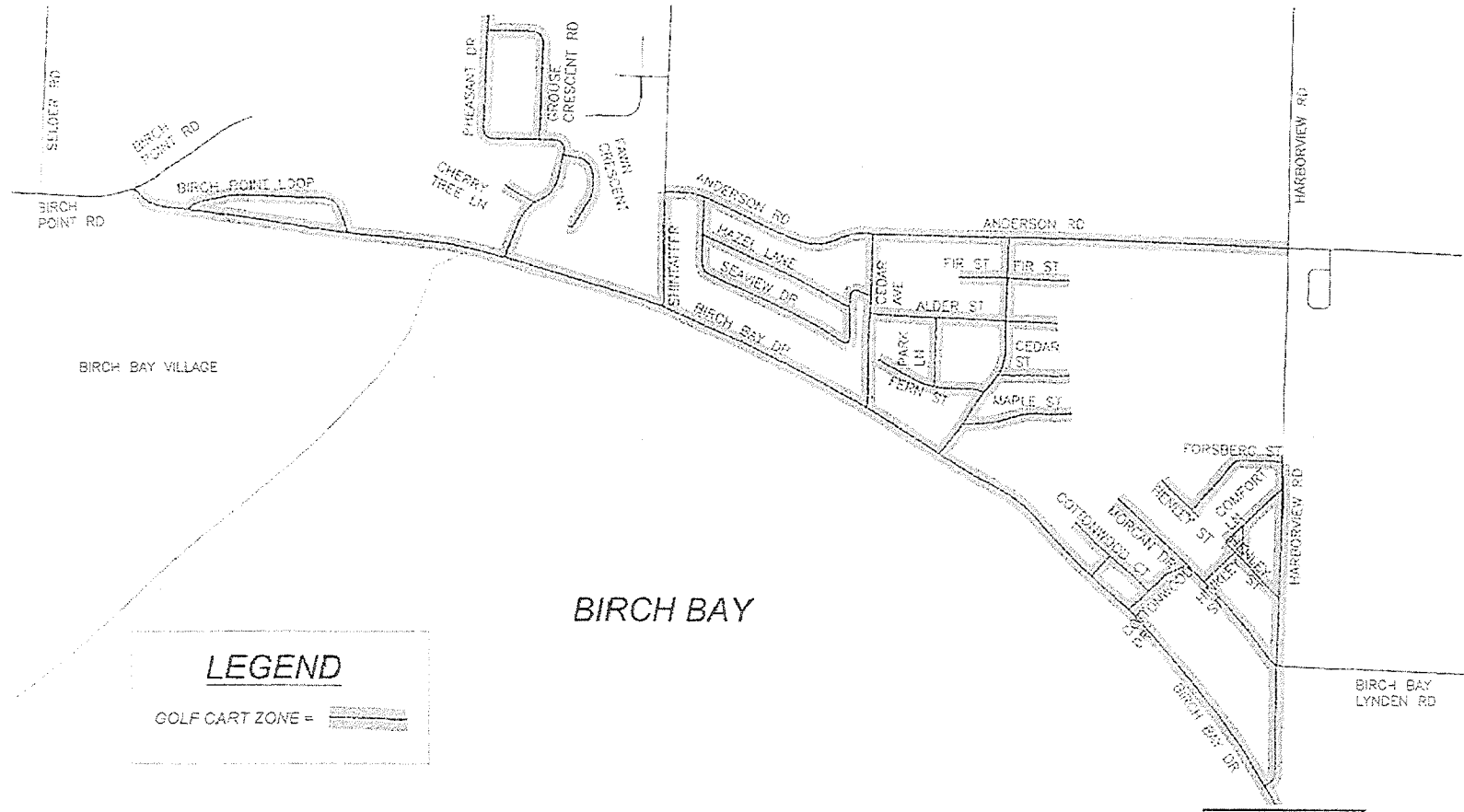

BIRCH BAY VILLAGE

BIRCH BAY

LEGEND

GOLF CART ZONE =

SEE ATTACHMENT "B"



ATTACHMENT "C"

DEPARTMENT OF PUBLIC WORKS
112 N. COMMERCIAL ST., SUITE 301
BELLINGHAM, WA 98225
(360) 778-6210

SEE ATTACHMENT "B"

SITUATE IN A PORTION OF SECTION 31
TOWNSHIP 40 NORTH, RANGE 1 EAST,
W.M. & SECTION 36, TOWNSHIP
40 NORTH, RANGE 1 WEST, W.M.
WHATCOM COUNTY, WASHINGTON

LEGEND

GOLF CART ZONE = 

BIRCH BAY

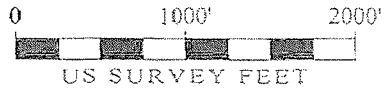

SEE ATTACHMENT "D"

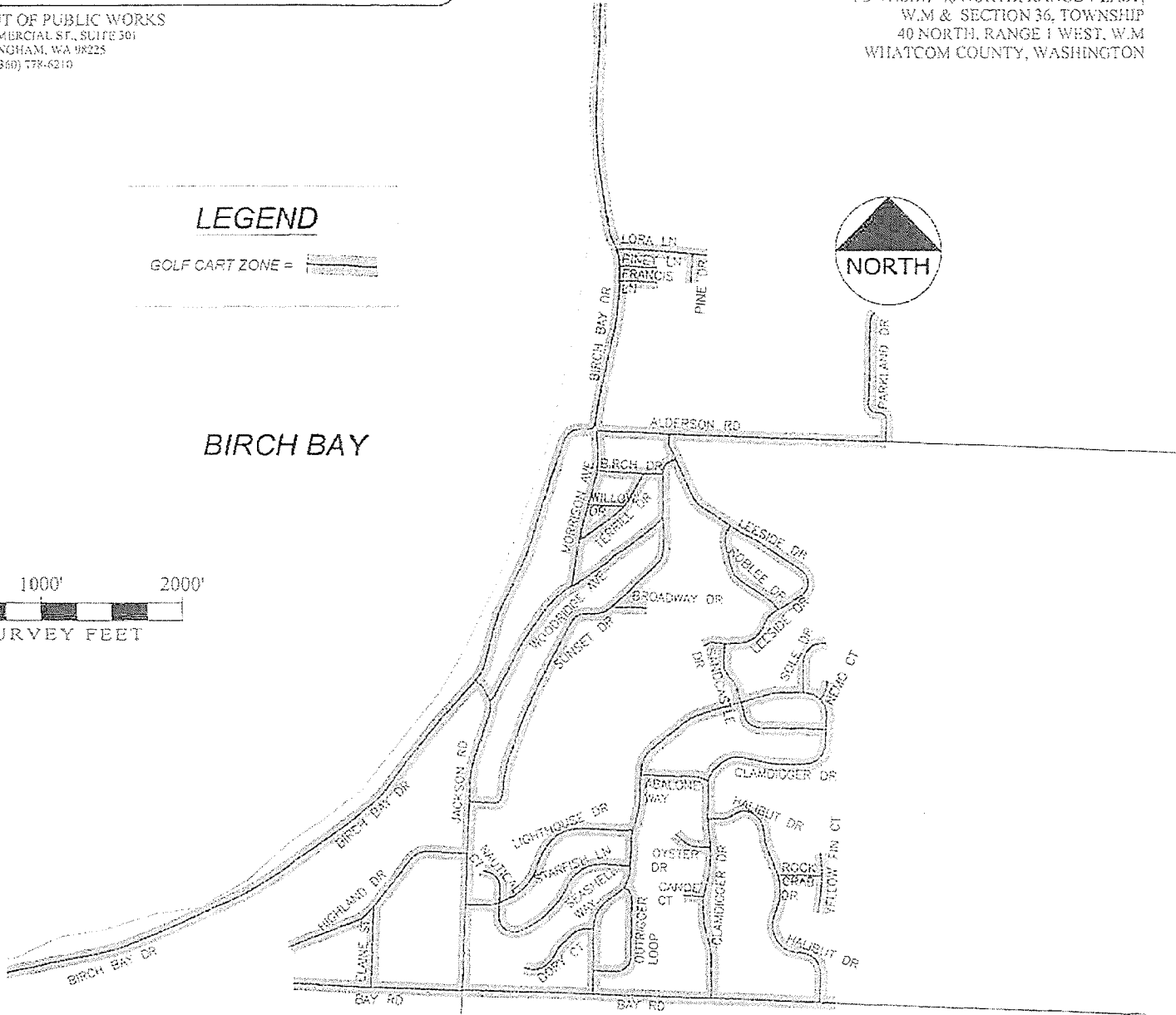



ATTACHMENT "D"

DEPARTMENT OF PUBLIC WORKS
322 N. COMMERCIAL ST., SUITE 301
BELLINGHAM, WA 98225
(360) 778-6219

SITUATE IN A PORTION OF SECTION 2
TOWNSHIP 39 NORTH, RANGE 1 WEST, W.M.
WHATCOM COUNTY, WASHINGTON

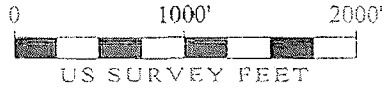

LEGEND

GOLF CART ZONE =

BIRCH BAY



SEE ATTACHMENT "C"

