

# TO ALL COUNCILMEMBERS:

**November 21, 2017**

## **SUBSTITUTE FOR COUNCIL ACTION**

2. Ordinance amending Whatcom County Code 2.118, reactivating the Whatcom County Wildlife Advisory Committee (AB2017-318)  
**Pages 68 - 74**

## **SUBSTITUTES FOR INTRODUCTION**

6. Ordinance establishing the Lake Whatcom Stormwater Utility District (AB2017-251C) **Pages 75 - 87**
8. Ordinance establishing Whatcom County Code 2.126, Climate Impact Advisory Committee (AB2017-351) **Pages 88 - 97**

*DISTRIBUTED: November 21, 2017*  
*TIME: 4:00 p.m.*

1 PROPOSED BY: \_\_\_\_\_

2 INTRODUCTION DATE: November 8, 2017

3  
4 ORDINANCE NO. \_\_\_\_\_

5  
6 **AMENDING WHATCOM COUNTY CODE 2.118, REACTIVATING THE WHATCOM**  
7 **COUNTY WILDLIFE ADVISORY COMMITTEE**

8  
9 **WHEREAS**, the Washington State Growth Management Act (GMA) requires  
10 Whatcom County to engage in comprehensive land use planning; and

11  
12 **WHEREAS**, the GMA indicates that Whatcom County's comprehensive land use  
13 planning efforts should foster land use patterns and develop a local vision of rural  
14 character that will be compatible with the use of the land by wildlife and for fish and  
15 wildlife habitat; and

16  
17 **WHEREAS**, goal nine (9) of the GMA, in Revised Code of Washington (RCW)  
18 36.70A.020, is to retain open space, enhance recreational opportunities, conserve fish  
19 and wildlife habitat, increase access to natural resource lands and water, and develop  
20 parks and recreation facilities; and

21  
22 **WHEREAS**, in RCW 36.70A.160, the GMA directs local governments to identify  
23 open space corridors within and between urban growth areas useful for recreation,  
24 wildlife habitat, trails and connections between critical areas; and

25  
26 **WHEREAS**, habitat conservation areas must be identified, designated and  
27 protected through the use of best available science, according to RCW 36.70A.172; and

28  
29 **WHEREAS**, goal eleven (11) of the GMA is to encourage the involvement of  
30 citizens in the planning process and ensure coordination between communities and  
31 jurisdictions to reconcile conflicts; and

32  
33 **WHEREAS**, Whatcom County citizens have expressed to the County Council their  
34 desire for the County to incorporate wildlife management and conservation planning for  
35 fish and wildlife habitat into the Whatcom County land use planning process; and

36  
37 **WHEREAS**, the Whatcom County Council would benefit from the advice and  
38 recommendations of those with background and technical expertise, including but not  
39 limited to, in wildlife management, conservation science, and wildlife biology, when  
40 making land use policy decisions, and

41  
42 **WHEREAS**, the County Council acknowledges the community has finite resources  
43 requiring good fiscal and environmental stewardship, and the community would benefit  
44 from achievable wildlife management recommendations, and;

1           **WHEREAS**, the County Council recognizes people are part of the landscape and  
2 within a watershed diverse uses interact and depend on limited resources, requiring  
3 balanced wildlife management recommendations which provide visible community and  
4 ecological services, and;  
5

6           **WHEREAS**, the County Council authorizes Planning and Development Services  
7 Department to fund a .25 FTE to staff the wildlife advisory committee.  
8

9           **NOW, THEREFORE, BE IT ORDAINED** by the Whatcom County Council that  
10 Whatcom County Code 2.118, creating the Whatcom County Wildlife Advisory  
11 Committee, is hereby established as outlined in Exhibit A of this ordinance, and;  
12

13           **BE IT FINALLY ORDAINED** by the Whatcom County Council that this ordinance  
14 will sunset within one year of its adoption.  
15

16  
17  
18           **ADOPTED** this \_\_\_\_ day of \_\_\_\_\_, 2017.  
19  
20

21  
22 ATTEST:

WHATCOM COUNTY COUNCIL  
WHATCOM COUNTY, WASHINGTON

23  
24  
25  
26 \_\_\_\_\_  
Dana Brown-Davis, Clerk of the Council

\_\_\_\_\_  
Barry Buchanan, Council Chair

27  
28  
29  
30 APPROVED AS TO FORM:

WHATCOM COUNTY EXECUTIVE  
WHATCOM COUNTY, WASHINGTON

31  
32  
33  
34 \_\_\_\_\_  
Civil Deputy Prosecutor

\_\_\_\_\_  
Jack Louws, County Executive

(    ) Approved      (    ) Denied

Date Signed: \_\_\_\_\_  
40  
41

# EXHIBIT A

## Chapter 2.118 WILDLIFE ADVISORY COMMITTEE

### Sections:

- 2.118.010 **Established**
- 2.118.020 **Purpose**
- 2.118.030 **Function**
- 2.118.040 **Qualifications**
- 2.118.050 **Membership**
- 2.118.060 **Term of Office**
- 2.118.070 **Organization – Meetings**
- 2.118.080 **Committee Staffing**

#### 2.118.010 **Established.**

The Wildlife Advisory Committee is hereby established.

#### 2.118.020 **Purpose.**

The committee will advise the Whatcom County Planning and Development Services Department staff and the Whatcom County Council on the value of wildlife and habitat management issues as they relate to the Whatcom County Comprehensive Plan, with the goal of integrating wildlife management and protection into the community planning process.

#### 2.118.030 **Function.**

- A. The committee will provide recommendations on integrating wildlife management and protection issues relative to fulfilling goal nine (9) of the Washington State Growth Management Act (GMA): to retain open space, enhance recreational opportunities, conserve fish and wildlife habitat, increase access to natural resource lands and water, and develop parks and recreation facilities. The full committee shall provide a recommendation on the need for an ongoing wildlife advisory committee.
- B. Each committee recommendation will consist of
  - i. Identified issue or constraint
  - ii. Discussion of ecological process, function or species addressed
  - iii. Range of solutions considered
  - iv. Preferred solution
  - v. Cost of implementation. A cost benefit analysis is required when an existing industry recognized method is available; at a minimum a discussion of project costs and positive or adverse impacts where community and ecological uses intersect.
  - vi. Cited and reviewed references

1 C. The Technical Advisory sub-committee, as defined in Section  
2 2.118.050(B), will:  
3

- 4 i. ~~Prior to the end of 2015, develop the~~Continue to provide periodic  
5 updates to the Ecosystem Report that includes initial inventory,  
6 characterization, and assessment, which includes an analysis of  
7 risk, of existing ecosystem conditions (Existing Condition Report),  
8 and to make management recommendations using best available  
9 science that will provide appropriate habitat conditions for local  
10 species, with an emphasis on biodiversity and healthy ecosystem  
11 processes and functions. This may include recommendations  
12 regarding wildlife corridors, landscape ecological planning, wildlife  
13 management, avoiding human/wildlife conflict.  
14
- 15 ii. ~~Continue to provide periodic updates to the Existing Condition~~  
16 ~~Report or to~~A address technical questions from the Whatcom  
17 County Council, Whatcom County staff, or the Wildlife  
18 Management Committee.  
19

20 **2.118.040 Qualifications.**

21 To qualify for County Council appointment to fill any vacancy on a board,  
22 committee, or commission, a person shall be a qualified registered voter  
23 and be a member or employee of the agency or group he or she is  
24 appointed to represent.  
25

26 **2.118.050 Membership.**

- 27
- 28 A. The committee shall consist of 11 members.
- 29
- 30 B. Seven of the 11 members will have technical expertise in wildlife  
31 and habitat management or current or past professional experience  
32 such as, but not limited to, at least one of the following: wetlands  
33 manager, wildlife biologist, population biologist, natural resources  
34 manager, watershed scientist, conservation specialist, forestry  
35 protection, and tribal representative.  
36

37 ~~C. The County Council will appoint the voting committee members.~~  
38 ~~Member terms will be four years.~~  
39

40 ~~D.~~ The committee members shall serve without compensation.  
41

42 **2.118.060 Term of Office.**

43  
44 The committee shall serve until ~~July 31, 2016~~December 31, 2022.  
45

46 **2.118.070 Organization – Meetings.**

- 47
- 48 A. Meetings of the committee shall be open and accessible to the  
49 public and shall be subject to the Open Public Meetings Act.  
50

1  
2  
3  
4  
5  
6  
7  
8  
9  
10  
11  
12  
13  
14  
15  
16  
17  
18  
19  
20  
21  
22  
23  
24  
25  
26  
27  
28  
29  
30  
31  
32  
33  
34

- B. The committee shall ~~determine its own meeting schedule, but shall meet at least bimonthly~~ meet as needed to address wildlife related planning needs.
- C. The committee shall be responsible for taking complete and accurate written records.
- D. Whatcom County staff shall be responsible for assuring the meetings are audio recorded.
- E. Written and audio recordings of meetings, resolutions, findings, and recommendations shall be kept, and such records shall be public.
- F. The committee shall comply with Whatcom County Code 2.03 – Boards and Commissions.
- G. The committee shall adopt its own rules and procedures for the conduct of business.
- H. The committee shall elect a chairperson from among its members who shall preside at its meetings.

**2.118.080 Committee Staffing.**

- A. The Whatcom County Planning and Development Services Department and Whatcom County Public Works Department shall provide geographic information system (GIS) data and other information to the committee as requested.
- B. The Whatcom County Planning and Development Services Department and the Whatcom County Public Works Department shall provide technical assistance and assist with meeting coordination.

ORDINANCE NO. 2017-\_\_\_\_\_

ESTABLISHING THE  
LAKE WHATCOM STORMWATER UTILITY ~~DISTRICT~~SERVICE AREA

WHEREAS, Lake Whatcom is the drinking water source for approximately 100,000 Whatcom County residents; and

WHEREAS, concerns about the Lake's water quality have been expressed by various citizens and entities since at least 1988; and

WHEREAS, in 1992 the City of Bellingham, Whatcom County, and the predecessor of the Lake Whatcom Water and Sewer District jointly formed the Lake Whatcom Management Program and thereby declared their intention to work together to protect and manage Lake Whatcom; and

WHEREAS, Lake Whatcom was first listed on the 303(d) list of impaired water bodies under the federal Clean Water Act for low levels of dissolved oxygen related to excessive levels of phosphorus and excessive levels of fecal coliform in tributaries in 1998; and

WHEREAS, the Lake Whatcom Management Program coordinates actions of the member governments to improve the Lake, including, but not limited to reducing phosphorus and fecal coliform entering the Lake; and

WHEREAS, a Total Maximum Daily Load (TMDL) Report of Findings for total phosphorus and fecal coliform in the Lake Whatcom Watershed was approved by the Washington State Department of Ecology (DOE) and the United States Environmental Protection Agency (EPA) in 2016; and

WHEREAS, the TMDL requires the development of an implementation plan identifying measures to be taken by the City of Bellingham and Whatcom County to reduce total phosphorus and fecal coliform in Lake Whatcom, which will become incorporated into the National Pollutant Discharge Elimination System (NPDES) stormwater permit for western Washington when that permit is renewed; and,

WHEREAS, as permittees, the City of Bellingham and Whatcom County have committed to substantial investments in stormwater infrastructure and private homeowner incentives to improve water quality; and

WHEREAS, in 2017 Whatcom County approved an update to the Lake Whatcom Comprehensive Stormwater Plan that identifies specific projects needed to reduce phosphorus-laden runoff entering the Lake to fulfill the requirements in the TMDL implementation plan; and

WHEREAS, the City of Bellingham has established a stormwater utility to provide a funding source to address the phosphorus reduction funding needs within the incorporated portion of the Lake Whatcom watershed; and

WHEREAS, a funding source is needed to address the phosphorus reduction funding needs in the unincorporated portion of the Lake Whatcom watershed; and

WHEREAS, RCW 36.89 authorizes counties to establish stormwater utilities to fund the cost and expense of maintaining and operating storm water control facilities and the cost and expense of planning, designing, establishing, acquiring, developing, constructing and improving any of such facilities in all or portions of a county; and

WHEREAS, it is the intent of the Whatcom County Council to authorize an assessment for the collection of revenue for fulfilling the TMDL implementation plan including the Lake Whatcom Comprehensive Stormwater Plan; and

WHEREAS, a map and legal description of the Lake Whatcom Stormwater Utility ~~District~~Service Area is included in this resolution as Exhibit "A"; and

WHEREAS, on September 26, 2017, the Whatcom County Council passed a resolution calling for the development of a special funding district in the unincorporated portion of the Lake Whatcom watershed to provide local fees to be used in conjunction with other funding to address water quality concerns specific to Lake Whatcom and requesting staff to bring forth an ordinance establishing such a district to the County Council for approval; and

WHEREAS, on October 17, 2017, the Whatcom County Council selected a stormwater utility ~~district~~ established under RCW 36.89 as the special funding ~~district~~mechanism for the Lake Whatcom watershed; and

WHEREAS, a public hearing was held on December 5, 2017, for the establishment of the Lake Whatcom Stormwater Utility ~~District~~Service Area at the regular Whatcom County Council meeting.



NOW, TIHEREFORE, BE IT ORDAINED by the Whatcom County Council that the Lake Whatcom Stormwater Utility ~~District~~Service Area is hereby established, as enabled by RCW 36.89, with its boundaries set as described in Exhibit A, attached hereto and incorporated by reference.

ADOPTED this \_\_\_\_\_ day of \_\_\_\_\_, 2017.

ATTEST

WHATCOM COUNTY COUNCIL  
WHATCOM COUNTY, WASHINGTON

\_\_\_\_\_  
Dana Brown Davis, Clerk of the Council

\_\_\_\_\_  
Barry Buchanan, Council Chair

APPROVED AS TO FORM:

WHATCOM COUNTY EXECUTIVE  
WHATCOM COUNTY, WASHINGTON

\_\_\_\_\_  
Civil Deputy Prosecutor

\_\_\_\_\_  
Jack Louws, County Executive  
( ) Approved      ( ) Denied

Date Signed: \_\_\_\_\_

## EXHIBIT "A"

### Lake Whatcom Stormwater Utility District Service Area as formed under RCW 36.89

#### Boundary Legal Description

THE LAKE WHATCOM STORMWATER UTILITY DISTRICT SERVICE AREA CONTAINING ALL OR PORTIONS OF SECTIONS 13, 14, 15, 22, 23, 24, 25, 26, 27, 34, 35 AND 36, TOWNSHIP 38 NORTH, RANGE 3 EAST, W.M., SECTIONS 1, 2, 3, 11, 12, 13 AND 24, TOWNSHIP 37 NORTH, RANGE 3 EAST, W.M., SECTIONS 17, 18, 19, 20, 21, 22, 26, 27, 28, 29, 30, 31, 32, 33, 34 AND 35 TOWNSHIP 38 NORTH, RANGE 4 EAST, W.M., SECTIONS 2, 3, 4, 5, 6, 7, 8, 9, 10, 14, 15, 16, 17, 18, 19, 20, 21, 22, 23, 24, 25, 26, 27, 28, 29, 33, 34, AND 35, TOWNSHIP 37 NORTH, RANGE 4 EAST, W.M., AND SECTIONS 30 AND 31, TOWNSHIP 37 NORTH, RANGE 5 EAST, W.M., SAID DISTRICT SERVICE AREA BOUNDARY MORE PARTICULARLY DESCRIBED AS FOLLOWS:

BEGINNING AT THE NORTHWEST CORNER OF THE WEST 100.00 FEET OF LOT 1, AS MEASURED ALONG THE SOUTH LINE THEREOF, IN BLOCK 1, MCCUE'S GARDEN TRACTS, WHATCOM COUNTY, WASHINGTON, AS PER THE MAP THEREOF, RECORDED IN VOLUME 6 OF PLATS, PAGE 42, IN THE AUDITOR'S OFFICE OF SAID COUNTY AND STATE; THENCE SOUTHERLY ALONG THE WEST LINE OF SAID LOT 1 TO THE NORTHEAST CORNER OF LOT 3, GINA LYNEE SHORT PLAT; THENCE WESTERLY ALONG THE NORTH LINE OF SAID SHORT PLAT TO THE NORTHWEST CORNER OF LOT 2 OF SAID SHORT PLAT; THENCE SOUTHERLY ALONG THE WESTERLY LINE OF SAID LOT 2 AND THE EXTENSION THEREOF TO THE SOUTHERLY RIGHT OF WAY MARGIN OF YORK STREET; THENCE WESTERLY ALONG SAID SOUTHERLY RIGHT OF WAY MARGIN TO THE NORTHWEST CORNER OF LOT 4, CEDARBROOK 1<sup>ST</sup> ADDITION; THENCE SOUTHERLY ALONG THE WEST LINE OF SAID LOT 4 TO THE NORTHWEST CORNER OF LOT 5 OF SAID CEDARBROOK 1<sup>ST</sup> ADDITION; THENCE SOUTHEASTERLY ALONG THE NORTHEASTERLY LINE OF SAID LOT 5 TO THE NORTHEAST CORNER OF SAID LOT 5; THENCE SOUTHWESTERLY ALONG THE EASTERLY LINE OF SAID LOT 5 TO THE SOUTHEAST CORNER OF SAID LOT 5; THENCE SOUTHWESTERLY ALONG THE SOUTHERLY LINE OF SAID LOT 5 TO THE SOUTHWEST CORNER OF SAID LOT 5, SAID SOUTHWEST CORNER ALSO BEING A POINT ON THE WEST LINE OF SECTION 27, TOWNSHIP 38 NORTH, RANGE 3 EAST OF W.M.; THENCE SOUTHERLY ALONG SAID WEST LINE TO THE NORTHWEST CORNER OF SECTION 34, TOWNSHIP 38 NORTH, RANGE 3 EAST, W.M.; THENCE SOUTHERLY ALONG THE WEST LINE OF SAID SECTION 34 TO THE SOUTHWEST CORNER OF SAID SECTION 34; THENCE EASTERLY ALONG THE SOUTH LINE OF SAID SECTION 34 TO THE QUARTER SECTION CORNER COMMON TO SECTION 34, TOWNSHIP 38 NORTH, RANGE 3 EAST, W.M. AND SECTION 3, TOWNSHIP 37 NORTH RANGE 3 EAST W.M.; THENCE SOUTHERLY ALONG THE NORTH-SOUTH CENTERLINE OF SAID SECTION 3 TO THE CENTER OF SAID SECTION 3; THENCE EASTERLY ALONG THE EAST-WEST CENTERLINE OF SAID SECTION 3 TO THE EAST QUARTER CORNER OF SAID SECTION 3; THENCE SOUTHERLY ALONG THE EAST LINE OF SAID SECTION 3 TO THE NORTHWEST CORNER OF SECTION 11, TOWNSHIP 37 NORTH, RANGE 3 EAST, W.M.; THENCE SOUTHERLY ALONG THE WEST LINE OF SAID SECTION 11 TO THE NORTHWEST CORNER OF THE SOUTHWEST QUARTER OF THE NORTHWEST QUARTER OF SAID SECTION 11; THENCE EASTERLY ALONG THE NORTH LINE OF SAID SOUTHWEST QUARTER OF THE NORTHWEST QUARTER OF SAID SECTION 11 TO THE NORTHEAST CORNER OF THE SOUTHWEST QUARTER OF THE NORTHWEST QUARTER OF SAID SECTION 11; THENCE SOUTHERLY ALONG THE EAST LINE OF SAID SOUTHWEST QUARTER OF THE NORTHWEST QUARTER TO THE SOUTHEAST CORNER OF SAID SOUTHWEST QUARTER OF THE NORTHWEST QUARTER; THENCE EASTERLY ALONG THE EAST-WEST CENTERLINE OF SAID SECTION 11 TO THE EAST QUARTER CORNER OF SAID SECTION 11; THENCE SOUTHERLY ALONG THE EAST LINE OF SAID SECTION 11 TO THE NORTHWEST CORNER OF THE SOUTHWEST QUARTER OF THE SOUTHWEST QUARTER OF SECTION 12, TOWNSHIP 37 NORTH, RANGE 3 EAST, W.M.; THENCE EASTERLY ALONG THE NORTH LINE OF SAID SOUTHWEST QUARTER OF THE SOUTHWEST QUARTER TO THE NORTHEAST CORNER OF SAID SOUTHWEST QUARTER OF

THE SOUTHWEST QUARTER; THENCE SOUTHERLY ALONG THE EAST LINE OF SAID SOUTHWEST QUARTER OF THE SOUTHWEST QUARTER TO THE SOUTHEAST CORNER OF SAID SOUTHWEST QUARTER OF THE SOUTHWEST QUARTER; THENCE EASTERLY ALONG THE SOUTH LINE OF SAID SECTION 12 TO THE NORTH QUARTER CORNER OF SECTION 13, TOWNSHIP 37 NORTH, RANGE 3 EAST, W.M.; THENCE SOUTHERLY ALONG THE NORTH-SOUTH CENTERLINE OF SAID SECTION 13 TO THE NORTHWEST CORNER OF THE SOUTHWEST QUARTER OF THE NORTHEAST QUARTER OF SAID SECTION 13; THENCE EASTERLY ALONG THE NORTH LINE OF SAID SOUTHWEST QUARTER OF THE NORTHEAST QUARTER TO THE NORTHEAST CORNER OF SAID SOUTHWEST QUARTER OF THE NORTHEAST QUARTER; THENCE SOUTHERLY ALONG THE EAST LINE OF SAID SOUTHWEST QUARTER OF THE NORTHEAST QUARTER TO THE SOUTHEAST CORNER OF SAID SOUTHWEST QUARTER OF THE NORTHEAST QUARTER; THENCE SOUTHERLY ALONG THE WEST LINE OF THE NORTHEAST QUARTER OF THE SOUTHEAST QUARTER AND THE SOUTHEAST QUARTER OF THE SOUTHEAST QUARTER OF SAID SECTION 13 TO THE NORTHWEST CORNER OF THE NORTHEAST QUARTER OF THE NORTHEAST QUARTER OF SECTION 24, TOWNSHIP 37 NORTH, RANGE 3 EAST, W.M.; THENCE SOUTHERLY ALONG THE WEST LINE OF THE NORTHEAST QUARTER OF THE NORTHEAST QUARTER AND THE SOUTHEAST QUARTER OF THE NORTHEAST QUARTER OF SAID SECTION 24 TO THE NORTHWEST CORNER OF THE NORTHEAST QUARTER OF THE SOUTHEAST QUARTER OF SAID SECTION 24; THENCE SOUTHERLY ALONG THE WEST LINE OF SAID NORTHEAST QUARTER OF THE SOUTHEAST QUARTER TO THE SOUTHWEST CORNER OF SAID NORTHEAST QUARTER OF THE SOUTHEAST QUARTER; THENCE EASTERLY ALONG THE SOUTHERLY LINE OF SAID NORTHEAST QUARTER OF THE SOUTHEAST QUARTER TO THE SOUTHEAST CORNER OF SAID NORTHEAST QUARTER OF THE SOUTHEAST QUARTER; THENCE SOUTHERLY ALONG THE EAST LINE OF SAID SECTION 24 TO THE SOUTHWEST CORNER OF SECTION 19, TOWNSHIP 37 NORTH, RANGE 4 EAST, W.M.; THENCE EASTERLY ALONG THE SOUTH LINE OF SAID SECTION 19 TO THE SOUTH QUARTER CORNER OF SAID SECTION 19; THENCE NORTHERLY ALONG THE NORTH-SOUTH CENTERLINE OF SAID SECTION 19 TO THE NORTHWEST CORNER OF THE SOUTHWEST QUARTER OF THE SOUTHEAST QUARTER OF SAID SECTION 19; THENCE EASTERLY ALONG THE NORTH LINE OF SAID SOUTHWEST QUARTER OF THE SOUTHEAST QUARTER TO THE NORTHEAST CORNER OF SAID SOUTHWEST QUARTER OF THE SOUTHEAST QUARTER; THENCE NORTHERLY ALONG THE WEST LINE OF THE NORTHEAST QUARTER OF THE SOUTHEAST QUARTER OF SAID SECTION 19 TO THE NORTHWEST CORNER OF SAID NORTHEAST QUARTER OF THE SOUTHEAST QUARTER; THENCE EASTERLY ALONG THE NORTH LINE OF SAID NORTHEAST QUARTER OF THE SOUTHEAST QUARTER TO THE EAST QUARTER CORNER OF SAID SECTION 19; THENCE SOUTHERLY ALONG THE EAST LINE OF SAID SECTION 19 TO THE NORTHWEST CORNER OF SECTION 29, TOWNSHIP 37 NORTH, RANGE 4 EAST, W.M.; THENCE EASTERLY ALONG THE NORTH LINE OF SAID SECTION 29 TO THE NORTHEAST CORNER OF THE NORTHWEST QUARTER OF THE NORTHWEST QUARTER OF SAID SECTION 29; THENCE SOUTHERLY TO THE NORTHWEST CORNER OF LOT 42, BLOCK 1, GLENHAVEN LAKES DIV. NO. 11; THENCE EASTERLY ALONG THE NORTH LINE OF SAID GLENHAVEN LAKES DIV. NO. 11 TO THE NORTHEAST CORNER OF LOT 6, BLOCK 2 OF SAID GLENHAVEN LAKES DIV. NO. 11; THENCE SOUTHWESTERLY ALONG THE EASTERLY LINE OF SAID LOT 6 TO THE NORTHERLY RIGHT OF WAY MARGIN OF PEAK ROAD; THENCE SOUTHEASTERLY ALONG SAID RIGHT OF WAY MARGIN TO THE MOST SOUTHERLY CORNER OF LOT 8, BLOCK 2, OF SAID GLENHAVEN LAKES DIV. NO. 11; THENCE NORTHEASTERLY ALONG THE EASTERLY LINE OF SAID LOT 8 TO THE MOST NORTHERLY CORNER OF LOT 12, BLOCK 2 OF SAID GLENHAVEN LAKES DIV. NO. 11; THENCE SOUTHEASTERLY ALONG THE EASTERLY LINE OF SAID LOT 12 TO THE NORTHWESTERLY RIGHT OF WAY MARGIN OF ASH WAY; THENCE CONTINUING SOUTHEASTERLY ALONG THE EXTENSION OF THE NORTHEASTERLY LINE OF SAID LOT 12 TO THE SOUTHEASTERLY RIGHT OF WAY MARGIN OF WEST ROAD; THENCE NORTHEASTERLY ALONG SAID SOUTHEASTERLY RIGHT OF WAY MARGIN TO THE MOST WESTERLY CORNER OF LOT 17, BLOCK 4 OF SAID GLENHAVEN LAKES DIV. NO. 11; THENCE SOUTHEASTERLY ALONG THE SOUTHWESTERLY LINE OF SAID LOT 17 TO THE MOST SOUTHERLY CORNER OF SAID LOT 17 SAID CORNER ALSO BEING A POINT ON THE DIVIDING LINE BETWEEN GLENHAVEN LAKES DIV. NO. 11 AND GLENHAVEN LAKES DIV. NO. 10; THENCE NORTHEASTERLY ALONG SAID DIVIDING LINE TO THE MOST WESTERLY CORNER OF LOT 24, BLOCK 3, OF SAID GLENHAVEN LAKES DIV. NO. 10; THENCE SOUTHEASTERLY ALONG THE SOUTHWESTERLY LINE OF SAID LOT 24 TO THE NORTHWESTERLY RIGHT OF WAY MARGIN OF SUMERSET WAY; THENCE CONTINUING SOUTHEASTERLY ALONG THE EXTENSION OF SAID SOUTHWESTERLY LINE TO THE

SOUTHEASTERLY RIGHT OF WAY MARGIN OF SUMERSET WAY; THENCE NORTHEASTERLY ALONG SAID SOUTHEASTERLY RIGHT OF WAY MARGIN TO THE MOST WESTERLY CORNER OF LOT 2, BLOCK 6 OF SAID GLENHAVEN LAKES DIV. NO. 10; THENCE SOUTHEASTERLY ALONG THE SOUTHERLY LINE OF SAID LOT 2 TO THE MOST SOUTHEASTERLY CORNER OF SAID LOT 2, ALSO BEING A POINT ON THE NORTHWESTERLY RIGHT OF WAY MARGIN OF FERNAVEN LANE; THENCE NORTHEASTERLY TO THE SOUTHWESTERLY CORNER OF LOT 20, BLOCK 5 OF SAID GLENHAVEN LAKES DIV. NO. 10, ALSO BEING A POINT ON THE SOUTHEASTERLY RIGHT OF WAY MARGIN OF FERNAVEN LANE; THENCE SOUTHEASTERLY ALONG THE SOUTHERLY LINE OF SAID LOT 20 TO THE SOUTHEASTERLY CORNER OF SAID LOT 20, ALSO BEING A POINT ON THE NORTHWESTERLY RIGHT OF WAY MARGIN OF CAIN LAKE ROAD; THENCE SOUTHEASTERLY TO THE NORTHWESTERLY CORNER OF LOT E, UNRECORDED PARK RANCHETTES, ALSO BEING A POINT ON THE SOUTHEASTERLY RIGHT OF WAY MARGIN OF CAIN LAKE ROAD; THENCE SOUTHEASTERLY ALONG THE NORTHERLY LINE OF SAID LOT E TO THE NORTHEASTERLY CORNER OF SAID LOT E; THENCE SOUTHWESTERLY ALONG THE EASTERLY LINE OF SAID LOT E TO THE NORTHWEST CORNER OF LOT A, CAMPOS SHORT PLAT; THENCE EASTERLY ALONG THE NORTH LINE OF SAID CAMPOS SHORT PLAT TO THE NORTHEAST CORNER OF LOT B OF SAID SHORT PLAT; THENCE SOUTHERLY ALONG THE EASTERLY LINE OF SAID SHORT PLAT TO THE NORTHEAST CORNER OF LOT 2, SOUTH BAY RIDGE SHORT PLAT; THENCE SOUTHERLY ALONG THE EASTERLY LINE OF SAID SHORT PLAT TO THE SOUTHEAST CORNER OF LOT 4 OF SAID SHORT PLAT; THENCE WESTERLY ALONG THE SOUTH LINE OF SAID LOT 4 TO THE NORTHEAST CORNER OF A PARCEL DESCRIBED UNDER WHATCOM COUNTY AUDITOR'S FILE NO. 2016-0401205; THENCE SOUTHWESTERLY ALONG THE EASTERLY LINE OF SAID PARCEL TO THE CENTERLINE OF A CREEK AS SHOWN ON THAT CERTAIN RECORD OF SURVEY RECORDED UNDER WHATCOM COUNTY AUDITOR'S FILE NO. 2000800578; THENCE SOUTHEASTERLY ALONG SAID CREEK TO THE WEST LINE OF THE WEST HALF OF THE NORTHEAST QUARTER OF THE SOUTHEAST QUARTER OF SECTION 29, TOWNSHIP 37 NORTH, RANGE 4 EAST, W.M.; THENCE CONTINUING ALONG SAID CREEK TO THE NORTHEAST CORNER OF A PARCEL DESCRIBED UNDER WHATCOM COUNTY AUDITOR'S FILE NO. 1991202345; THENCE SOUTHERLY ALONG THE EAST LINE OF SAID PARCEL TO THE NORTH LINE OF THE SOUTHEAST QUARTER OF THE SOUTHEAST QUARTER OF SECTION 29, TOWNSHIP 37 NORTH, RANGE 4 EAST, W.M.; THENCE EASTERLY ALONG SAID NORTH LINE TO THE WEST LINE OF SECTION 28, TOWNSHIP 37 NORTH, RANGE 4 EAST W.M.; THENCE NORTHERLY ALONG SAID WEST LINE TO THE NORTHWEST CORNER OF A PARCEL DESCRIBED UNDER WHATCOM COUNTY AUDITOR'S FILE NO. 2050101389; THENCE EASTERLY ALONG THE NORTH LINE OF SAID PARCEL TO A POINT ON THE EAST LINE OF THE WEST HALF OF THE SOUTHWEST QUARTER OF SAID SECTION 28; THENCE SOUTHERLY ALONG SAID EAST LINE TO THE SOUTH LINE OF SAID SECTION 28; THENCE EASTERLY ALONG SAID SOUTH LINE TO THE NORTH QUARTER CORNER OF SECTION 33, TOWNSHIP 37 NORTH, RANGE 4 EAST, W.M.; THENCE SOUTHERLY ALONG THE NORTH-SOUTH CENTERLINE OF SAID SECTION 33 TO THE CENTER OF SAID SECTION 33; THENCE EASTERLY ALONG THE EAST-WEST CENTERLINE OF SAID SECTION 33 TO THE NORTHWESTERLY RIGHT OF WAY MARGIN OF CAMP 2 ROAD; THENCE SOUTHWESTERLY ALONG SAID RIGHT OF WAY MARGIN TO THE DIVIDING LINE BETWEEN WHATCOM COUNTY AND SKAGIT COUNTY; THENCE EASTERLY ALONG SAID DIVIDING LINE TO THE SOUTHEAST CORNER OF SECTION 35, TOWNSHIP 37 NORTH, RANGE 4 EAST, W.M.; THENCE NORTHERLY ALONG THE EAST LINE OF SAID SECTION 35 TO THE SOUTHWEST CORNER OF SECTION 25, TOWNSHIP 37 NORTH, RANGE 4 EAST, W.M.; THENCE EASTERLY ALONG THE SOUTH LINE OF SAID SECTION 25 TO THE NORTHWEST CORNER OF SECTION 31, TOWNSHIP 37 NORTH, RANGE 5 EAST, W.M.; THENCE EASTERLY ALONG THE NORTH LINE OF SAID SECTION 31 TO THE NORTH QUARTER CORNER OF SAID SECTION 31; THENCE SOUTHERLY ALONG THE NORTH-SOUTH CENTERLINE OF SAID SECTION 31 TO THE NORTHWEST CORNER OF A PARCEL DESCRIBED UNDER WHATCOM COUNTY AUDITOR'S FILE NO. 2101100490; THENCE EASTERLY ALONG THE NORTH LINE OF SAID PARCEL TO THE WESTERLY RIGHT OF WAY MARGIN OF STATE ROUTE NO. 9; THENCE NORTHERLY ALONG SAID WESTERLY RIGHT OF WAY MARGIN TO THE SOUTH LINE OF SECTION 30, TOWNSHIP 37 NORTH, RANGE 5 EAST, W.M.; THENCE WESTERLY ALONG SAID SOUTH LINE TO THE SOUTHWESTERLY RIGHT OF WAY MARGIN OF PARK ROAD; THENCE NORTHWESTERLY ALONG SAID RIGHT OF WAY MARGIN TO THE NORTH-SOUTH CENTERLINE OF SAID SECTION 30; THENCE NORTHERLY ALONG SAID NORTH-SOUTH CENTERLINE TO THE CENTER OF SAID SECTION 30; THENCE WESTERLY ALONG THE EAST-WEST CENTERLINE OF SAID SECTION 30 TO THE WEST LINE

OF THE EAST HALF OF THE NORTHWEST QUARTER OF SAID SECTION 30; THENCE NORTHERLY ALONG SAID WEST LINE TO THE NORTH LINE OF SAID SECTION 30; THENCE WESTERLY ALONG SAID NORTH LINE TO THE SOUTHWEST CORNER OF SECTION 19, TOWNSHIP 37 NORTH, RANGE 5 EAST, W.M.; THENCE NORTHERLY ALONG THE WEST LINE OF SAID SECTION 19 TO THE SOUTHEAST CORNER OF SECTION 13, TOWNSHIP 37 NORTH, RANGE 4 EAST, W.M.; THENCE WESTERLY ALONG THE SOUTH LINE OF SAID SECTION 13 TO THE SOUTHWEST CORNER OF SAID SECTION 13; THENCE NORTHERLY ALONG THE WEST LINE OF SAID SECTION 13 TO THE NORTHEAST CORNER OF SECTION 14, TOWNSHIP 37 NORTH, RANGE 4 EAST; THENCE WESTERLY ALONG THE NORTH LINE OF SAID SECTION 14 TO THE SOUTHEAST CORNER OF SECTION 10, TOWNSHIP 37 NORTH, RANGE 4 EAST, W.M.; THENCE NORTHERLY ALONG THE EAST LINE OF SAID SECTION 10 TO THE SOUTHWEST CORNER OF SECTION 2, TOWNSHIP 37 NORTH, RANGE 4 EAST, W.M.; THENCE EASTERLY ALONG THE SOUTH LINE OF SAID SECTION 2 TO THE WEST LINE OF THE EAST HALF OF THE SOUTHWEST QUARTER OF SAID SECTION 2; THENCE NORTHERLY ALONG SAID WEST LINE AND ALONG THE WEST LINE OF THE EAST HALF OF THE NORTHWEST QUARTER OF SAID SECTION 2 TO THE NORTH LINE OF SAID SECTION 2; THENCE EASTERLY ALONG THE NORTH LINE OF SAID SECTION 2 TO THE SOUTH QUARTER CORNER OF SECTION 35, TOWNSHIP 38 NORTH, RANGE 4 EAST, W.M.; THENCE NORTHERLY ALONG THE NORTH-SOUTH CENTERLINE OF SAID SECTION 35 TO THE SOUTH QUARTER CORNER OF SECTION 26, TOWNSHIP 38 NORTH, RANGE 4 EAST, W.M.; THENCE WESTERLY ALONG THE SOUTH LINE OF SAID SECTION 26 TO THE WEST LINE OF THE EAST HALF OF THE SOUTHWEST QUARTER OF SAID SECTION 26; THENCE NORTHERLY ALONG SAID WEST LINE TO THE SOUTHEAST CORNER OF THE SOUTHWEST QUARTER OF THE NORTHWEST QUARTER OF SAID SECTION 26; THENCE NORTHERLY ALONG THE EAST LINE OF SAID SOUTHWEST QUARTER OF THE NORTHWEST QUARTER TO THE NORTHEAST CORNER OF SOUTHWEST QUARTER OF THE NORTHWEST QUARTER OF SAID SECTION 26; THENCE WESTERLY ALONG THE NORTH LINE OF SAID SOUTHWEST QUARTER OF THE NORTHWEST QUARTER TO THE WEST LINE OF SAID SECTION 26; THENCE NORTHERLY ALONG SAID WEST LINE TO THE SOUTHEAST CORNER OF SECTION 22, TOWNSHIP 38 NORTH, RANGE 4 EAST, W.M.; THENCE NORTHERLY ALONG THE EAST LINE OF SAID SECTION 22 TO THE NORTHEAST CORNER OF SAID SECTION 22; THENCE WESTERLY ALONG THE NORTH LINE OF SAID SECTION 22 TO THE SOUTHEAST CORNER OF SECTION 16, TOWNSHIP 38 NORTH RANGE 4 EAST, W.M.; THENCE WESTERLY ALONG THE SOUTH LINE OF SAID SECTION 16 TO THE SOUTHEAST CORNER OF SECTION 17, TOWNSHIP 38 NORTH, RANGE 4 EAST, W.M.; THENCE NORTHERLY ALONG THE EAST LINE OF SAID SECTION 17 TO THE NORTH LINE OF THE SOUTH HALF OF THE SOUTHEAST QUARTER OF SAID SECTION 17; THENCE WESTERLY ALONG SAID NORTH LINE TO THE NORTH-SOUTH CENTERLINE OF SAID SECTION 17; THENCE NORTHERLY ALONG SAID NORTH-SOUTH CENTERLINE TO THE SOUTH LINE OF THE NORTH HALF OF THE NORTHWEST QUARTER OF SAID SECTION 17; THENCE WESTERLY ALONG SAID SOUTH LINE TO THE SOUTHEAST CORNER OF THE SOUTHWEST QUARTER OF THE NORTHEAST QUARTER OF THE NORTHWEST OF SAID SECTION 17; THENCE NORTHERLY ALONG THE EAST LINE OF SAID SOUTHWEST QUARTER OF THE NORTHEAST QUARTER OF THE NORTHWEST QUARTER TO THE NORTHEAST CORNER OF SAID SOUTHWEST QUARTER OF THE NORTHEAST QUARTER OF THE NORTHWEST QUARTER OF SAID SECTION 17; THENCE WESTERLY ALONG THE NORTH LINE OF SAID SOUTHWEST QUARTER OF THE NORTHEAST QUARTER OF THE NORTHWEST QUARTER TO THE NORTHWEST CORNER OF SAID SOUTHWEST QUARTER OF THE NORTHEAST QUARTER OF THE NORTHWEST QUARTER OF SAID SECTION 17; THENCE SOUTHERLY ALONG THE WEST LINE OF SAID SOUTHWEST QUARTER OF THE NORTHEAST QUARTER OF THE NORTHWEST QUARTER TO SAID SOUTH LINE OF THE NORTH HALF OF THE NORTHWEST QUARTER OF SAID SECTION 17; THENCE WESTERLY ALONG SAID SOUTH LINE TO THE WEST LINE OF SAID SECTION 17; THENCE NORTHERLY ALONG SAID WEST LINE TO THE NORTHEAST CORNER OF SECTION 18, TOWNSHIP 38 NORTH, RANGE 4 EAST, W.M.; THENCE WESTERLY ALONG THE NORTH LINE OF SAID SECTION 18 TO THE NORTH QUARTER CORNER OF SAID SECTION 18; THENCE SOUTHERLY ALONG THE NORTH-SOUTH CENTERLINE OF SAID SECTION 18 TO THE SOUTH LINE OF THE NORTH HALF OF THE NORTHEAST QUARTER OF THE NORTHWEST QUARTER OF SAID SECTION 18; THENCE WESTERLY ALONG SAID SOUTH LINE TO THE EAST LINE OF GOVERNMENT LOT 1 OF SAID SECTION 18; THENCE WESTERLY ALONG THE SOUTH LINE OF THE NORTH HALF OF SAID LOT 1 TO THE NORTHWEST CORNER OF "PARCEL NO. 28" AS DESCRIBED UNDER WHATCOM COUNTY AUDITOR'S FILE NO. 2016-0200579; THENCE SOUTHERLY ALONG THE WEST LINE OF SAID PARCEL TO THE NORTHWEST CORNER OF "PARCEL NO. 29" AS DESCRIBED

UNDER WHATCOM COUNTY AUDITOR'S FILE NO. 2016-0200579; THENCE SOUTHERLY ALONG THE WEST LINE OF SAID "PARCEL 29" TO THE SOUTH LINE OF GOVERNMENT LOT 2 OF SAID SECTION 18; THENCE WESTERLY ALONG SAID SOUTH LINE TO THE EAST QUARTER CORNER OF SECTION 13, TOWNSHIP 38 NORTH, RANGE 3 EAST, W.M.; THENCE WESTERLY ALONG THE EAST-WEST CENTERLINE OF SAID SECTION 13 TO THE NORTHWEST CORNER OF THE NORTHEAST QUARTER OF THE SOUTHEAST QUARTER OF SAID SECTION 13; THENCE SOUTHERLY ALONG THE WEST LINE OF SAID NORTHEAST QUARTER OF THE SOUTHEAST QUARTER TO THE INTERSECTION WITH THE NORTH LINE OF "PARCEL NO. 17" AS DESCRIBED UNDER WHATCOM COUNTY AUDITOR'S FILE NO. 2016-0200579; THENCE WESTERLY ALONG THE NORTH LINE OF SAID "PARCEL NO. 17" TO THE SOUTHEAST CORNER OF THE NORTH HALF OF THE NORTHEAST QUARTER OF THE SOUTHWEST QUARTER OF SAID SECTION 13; THENCE WESTERLY ALONG THE SOUTH LINE OF SAID NORTH HALF OF THE NORTHEAST QUARTER OF THE SOUTHWEST QUARTER OF SAID SECTION 13 TO THE SOUTHWEST CORNER OF SAID NORTH HALF OF THE NORTHEAST QUARTER OF THE SOUTHWEST QUARTER OF SAID SECTION 13 TO THE SOUTHERLY RIGHT OF WAY MARGIN OF FELDMAN ROAD; THENCE WESTERLY ALONG SAID RIGHT OF WAY MARGIN TO THE INTERSECTION WITH THE EXTENSION OF THE WEST LINE OF A PARCEL DESCRIBED UNDER WHATCOM COUNTY AUDITOR'S FILE NO. 2120603310; THENCE NORTHERLY ALONG SAID EXTENSION AND WEST LINE TO THE SOUTHERLY RIGHT OF WAY MARGIN OF SQUALICUM MOUNTAIN ROAD; THENCE WESTERLY ALONG SAID RIGHT OF WAY MARGIN TO THE WEST LINE OF "PARCEL A" AS SHOWN ON THAT CERTAIN RECORD OF SURVEY RECORDED UNDER WHATCOM COUNTY AUDITOR'S FILE NO. 2070804107; THENCE SOUTHERLY ALONG SAID WEST LINE TO THE SOUTH LINE OF "PARCEL A" AND "PARCEL B" AS SHOWN ON THAT CERTAIN RECORD OF SURVEY RECORDED UNDER WHATCOM COUNTY AUDITOR'S FILE NO. 2070804106; THENCE WESTERLY ALONG SAID SOUTH LINE AND THE EXTENSION THEREOF TO THE WEST LINE OF THE EAST HALF OF THE NORTHEAST QUARTER OF SECTION 14, TOWNSHIP 38 NORTH, RANGE 3 EAST, W.M.; THENCE NORTHERLY ALONG SAID WEST LINE TO THE NORTHEAST CORNER OF A PARCEL DESCRIBED UNDER WHATCOM COUNTY AUDITOR'S FILE NO. 1990603130; THENCE WESTERLY ALONG THE NORTH LINE OF SAID PARCEL TO THE NORTHWEST CORNER OF SAID PARCEL; THENCE NORTHERLY ALONG THE EXTENSION OF THE WEST LINE OF SAID PARCEL TO THE SOUTHEAST CORNER OF A PARCEL DESCRIBED UNDER WHATCOM COUNTY AUDITOR'S FILE NO. 1990603139; THENCE WESTERLY ALONG THE SOUTH LINE OF SAID PARCEL TO THE SOUTHWEST CORNER OF SAID PARCEL; THENCE NORTHERLY ALONG THE WEST LINE OF SAID PARCEL TO THE SOUTHEAST CORNER OF A PARCEL DESCRIBED UNDER WHATCOM COUNTY AUDITOR'S FILE NO. 1990603137; THENCE WESTERLY ALONG THE SOUTH LINE OF SAID PARCEL TO THE SOUTHWEST CORNER OF SAID PARCEL; THENCE SOUTHERLY ALONG THE EXTENSION OF THE WEST LINE OF SAID PARCEL TO THE SOUTHEAST CORNER OF THE SOUTH HALF OF THE NORTH HALF OF THE WEST HALF OF THE SOUTHEAST QUARTER OF THE NORTHWEST QUARTER OF SAID SECTION 14; THENCE WESTERLY ALONG THE SOUTH LINE OF SAID SOUTH HALF OF THE NORTH HALF OF THE WEST HALF OF THE SOUTHEAST QUARTER OF THE NORTHWEST QUARTER OF SAID SECTION 14 TO THE SOUTHWEST CORNER OF SOUTH HALF OF THE NORTH HALF OF THE EAST HALF OF THE SOUTHWEST QUARTER OF THE NORTHWEST QUARTER OF SAID SECTION 14; THENCE NORTHERLY ALONG THE WEST LINE OF SAID SOUTH HALF OF THE NORTH HALF OF THE EAST HALF OF THE SOUTHWEST QUARTER OF THE NORTHWEST QUARTER OF SAID SECTION 14 TO THE SOUTHEAST CORNER OF A PARCEL DESCRIBED AND DEPICTED UNDER WHATCOM COUNTY AUDITOR'S FILE NO. 1980302507; THENCE WESTERLY ALONG THE SOUTH LINE OF SAID PARCEL TO THE EASTERLY RIGHT OF WAY MARGIN OF TOAD LAKE ROAD; THENCE SOUTHERLY ALONG SAID RIGHT OF WAY MARGIN TO THE INTERSECTION WITH THE EXTENSION OF THE SOUTH LINE OF THE NORTH HALF OF THE SOUTHEAST QUARTER OF THE NORTHEAST QUARTER OF SECTION 15, TOWNSHIP 38 NORTH, RANGE 3 EAST, W.M.; THENCE WESTERLY ALONG SAID SOUTH LINE TO THE WEST LINE OF THE SOUTHEAST QUARTER OF THE NORTHEAST QUARTER OF SAID SECTION 15; THENCE SOUTHERLY ALONG SAID WEST LINE TO THE NORTHEAST CORNER OF A PARCEL DESCRIBED UNDER WHATCOM COUNTY AUDITOR'S FILE NO. 2050706353; THENCE WESTERLY ALONG THE NORTH LINE OF SAID PARCEL TO THE NORTHWEST CORNER OF SAID PARCEL; THENCE SOUTHERLY AND WESTERLY ALONG THE WEST LINE OF SAID PARCEL TO THE EASTERLY RIGHT OF WAY MARGIN OF BRITTON ROAD; THENCE SOUTHERLY ALONG SAID RIGHT OF WAY MARGIN

TO THE EAST-WEST CENTERLINE OF SAID SECTION 15; THENCE EASTERLY ALONG SAID EAST-WEST CENTERLINE TO THE NORTHWEST CORNER OF THE PLAT OF BROWNSVILLE; THENCE SOUTHERLY ALONG THE WEST LINE OF SAID PLAT TO THE NORTH LINE OF THE PLAT OF BRITTON GREEN; THENCE WESTERLY ALONG SAID NORTH LINE TO THE EASTERLY RIGHT OF WAY MARGIN OF BRITTON ROAD; THENCE SOUTHERLY ALONG SAID RIGHT OF WAY MARGIN TO THE INTERSECTION WITH THE EXTENSION OF THE NORTH LINE OF LOT 1, MANDEL SHORT PLAT, AS SHOWN ON THE PLAT OF SUNNYBROOK, RECORDED UNDER WHATCOM COUNTY AUDITOR'S FILE NO. 2070400646; THENCE WESTERLY ALONG SAID NORTH LINE AND THE EXTENSION THEREOF TO THE EAST LINE OF LOT 13 OF SAID PLAT OF SUNNYBROOK; THENCE SOUTHERLY ALONG SAID EAST LINE TO THE SOUTHEAST CORNER OF SAID LOT 13, ALSO BEING A POINT ON THE NORTH LINE OF GREENVILLE EAST DIV. NO. 1; THENCE WESTERLY ALONG THE NORTH LINE OF SAID GREENVILLE EAST DIV. NO. 1 TO THE EAST LINE OF A PARCEL DESCRIBED UNDER WHATCOM COUNTY AUDITOR'S FILE NO. 2040702618; THENCE NORTHERLY ALONG SAID EAST LINE TO THE NORTHEAST CORNER OF SAID PARCEL; THENCE WESTERLY ALONG THE NORTH LINE OF SAID PARCEL TO THE NORTHEAST CORNER OF A PARCEL DESCRIBED UNDER WHATCOM COUNTY AUDITOR'S FILE NO. 2016-0303015; THENCE WESTERLY ALONG THE NORTH LINE OF SAID PARCEL TO THE NORTHWEST CORNER OF SAID PARCEL; THENCE SOUTHERLY ALONG THE WEST LINE OF SAID PARCEL TO THE NORTH LINE OF GREENVILLE EAST DIV. NO. 2; THENCE WESTERLY ALONG SAID NORTH LINE TO THE NORTHWEST CORNER OF SAID GREENVILLE EAST DIV. NO. 2; THENCE SOUTHERLY ALONG THE WEST LINE OF SAID GREENVILLE EAST DIV. NO. 2 TO THE SOUTHWESTERLY LINE OF LOT 22, TWEED TWENTY DIV. NO. 5; THENCE NORTHWESTERLY ALONG SAID SOUTHWESTERLY LINE TO THE SOUTHEASTERLY RIGHT OF WAY MARGIN OF DEL BONITA WAY; THENCE SOUTHWESTERLY ALONG SAID RIGHT OF WAY MARGIN AND EXTENSION THEREOF TO THE SOUTHWESTERLY RIGHT OF WAY MARGIN OF SPRING COULEE ROAD; THENCE NORTHWESTERLY ALONG SAID RIGHT OF WAY MARGIN TO THE INTERSECTION WITH THE SOUTHEASTERLY RIGHT OF WAY MARGIN OF BEAZER ROAD; THENCE SOUTHWESTERLY ALONG SAID SOUTHEASTERLY RIGHT OF WAY MARGIN TO THE INTERSECTION WITH THE EXTENSION OF THE NORTHERLY LINE OF LOT 30, TWEED TWENTY DIV. NO. 3; THENCE WESTERLY ALONG SAID NORTHERLY LINE AND EXTENSION THEREOF TO THE EAST LINE OF LOT 1, PLAT OF "HERITAGE HILLS DIV. NO. 1"; THENCE NORTHERLY ALONG SAID EAST LINE TO THE NORTH LINE OF LOTS 1 AND 2 OF SAID PLAT OF "HERITAGE HILLS DIV. NO. 1"; THENCE WESTERLY ALONG THE NORTH LINE OF SAID LOTS 1 AND 2 TO THE EAST LINE OF TWEED TWENTY DIV. NO. 4; THENCE NORTHERLY ALONG SAID EAST LINE TO THE SOUTHEAST CORNER OF LOT 16 OF SAID TWEED TWENTY DIV. NO. 4; THENCE WESTERLY ALONG THE SOUTH LINE OF SAID LOT 16 TO THE EASTERLY RIGHT OF WAY MARGIN OF MAGRATH ROAD; THENCE SOUTHWESTERLY ALONG SAID RIGHT OF WAY MARGIN TO THE INTERSECTION OF SAID RIGHT OF WAY MARGIN AND THE EXTENSION OF THE NORTH LINE OF LOT 35, TWEED TWENTY DIV. NO. 4; THENCE WESTERLY ALONG SAID NORTH LINE AND THE EXTENSION THEREOF TO THE WEST LINE OF TWEED TWENTY DIV. NO. 4; THENCE SOUTHERLY ALONG SAID WEST LINE TO SOUTHWEST CORNER OF SAID TWEED TWENTY DIV. NO. 4, ALSO BEING THE NORTHWEST CORNER OF THE PLAT OF BRENTWOOD DIV. NO. 3B; THENCE EASTERLY ALONG THE NORTH LINE OF THE PLAT OF BRENTWOOD DIV. NO. 3B AND THE EXTENSION THEREOF TO THE NORTHWEST CORNER OF LOT A, THREE B'S SHORT PLAT; THENCE EASTERLY ALONG THE NORTH LINE OF SAID LOT A AND EXTENSION THEREOF TO THE NORTH-SOUTH CENTERLINE OF SECTION 22, TOWNSHIP 38 NORTH, RANGE 3 EAST, W.M.; THENCE SOUTHERLY ALONG SAID NORTH-SOUTH CENTERLINE TO THE INTERSECTION WITH THE NORTH LINE OF SILVER BEACH ON LAKE WHATCOM; THENCE EASTERLY ALONG THE SAID NORTH LINE TO THE EAST LINE OF SAID SECTION 22; THENCE SOUTHERLY ALONG SAID EAST LINE TO THE NORTHEAST CORNER OF SECTION 27, TOWNSHIP 38 NORTH, RANGE 3 EAST, W.M.; THENCE SOUTHERLY ALONG THE EAST LINE OF SAID SECTION 27 TO THE SOUTHWESTERLY RIGHT OF WAY MARGIN OF NORTHSHORE DRIVE; THENCE SOUTHEASTERLY ALONG SAID RIGHT OF WAY MARGIN TO THE MOST EASTERLY CORNER OF LOT 1, PEARCE'S SUBDIVISION; THENCE SOUTHWESTERLY ALONG THE SOUTHEASTERLY LINE OF SAID LOT 1 TO THE NORTHERLY MOST CORNER OF "PARCEL A" DESCRIBED UNDER WHATCOM COUNTY AUDITOR'S FILE NO. 2130101857; THENCE SOUTHEASTERLY ALONG THE NORTHEASTERLY LINE OF SAID "PARCEL A" TO THE SOUTHEASTERLY LINE THEREOF; THENCE SOUTHWESTERLY ALONG SAID SOUTHEASTERLY LINE TO THE INTERSECTION WITH SAID EAST LINE OF SECTION 27; THENCE SOUTHERLY ALONG SAID

EAST LINE TO THE INTERSECTION WITH THE NORTHEASTERLY BANK MEANDER LINE OF LAKE WHATCOM AS SHOWN ON THE MAP OF LAKE WHATCOM SHORE LANDS; THENCE SOUTHWESTERLY TO THE INTERSECTION OF THE EAST-WEST CENTERLINE OF SAID SECTION 27 WITH THE SOUTHWESTERLY BANK OF LAKE WHATCOM; THENCE WESTERLY ALONG SAID EAST-WEST CENTERLINE TO THE NORTHWEST CORNER OF THE "GURTNER PARCEL" AS SHOWN ON THAT CERTAIN RECORD OF SURVEY RECORDED UNDER WHATCOM COUNTY AUDITOR'S FILE NO. 901231198; THENCE SOUTHERLY ALONG THE WEST LINE OF SAID "GURTNER PARCEL" AND THE EXTENSION THEREOF TO THE NORTHWEST CORNER OF THE PLAT OF MAPLEBROOK; THENCE SOUTHERLY ALONG THE WEST LINE OF SAID PLAT TO THE NORTHEAST CORNER OF THE PLAT OF BROOK VIEW; THENCE WESTERLY ALONG THE NORTH LINE OF SAID PLAT OF BROOK VIEW AND THE EXTENSION THEREOF TO THE POINT OF BEGINNING.

EXCEPT ANY PORTION LYING WITHIN THE LIMITS OF THE CITY OF BELLINGHAM, WHATCOM COUNTY, WASHINGTON.

SITUATE IN WHATCOM COUNTY, WASHINGTON.  
LINES AND RIGHT OF WAY MARGINS TO BE LENGTHENED OR SHORTENED AS NECESSARY.



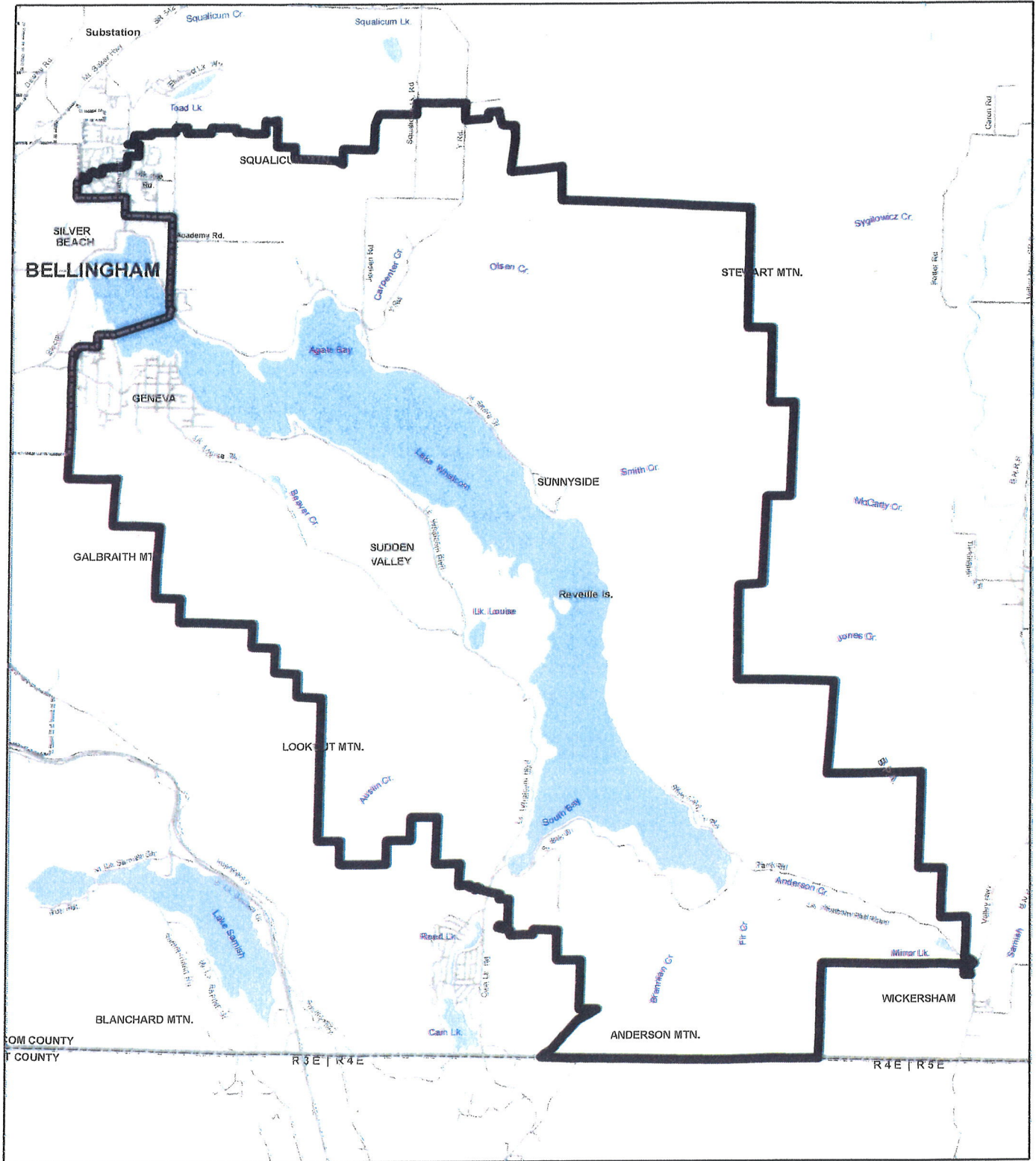

Lake Whatcom Stormwater  
Utility Service Area as formed  
under RCW 36.89



**Legend**

-  City Limits
-  Public Roads
-  Tax Parcel Boundaries
-  Lake Whatcom Stormwater Utility District

Date: 11/8/2017

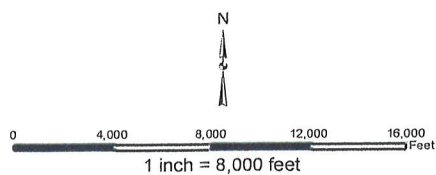

USE OF WHATCOM COUNTY'S GIS DATA IMPLIES THE USER'S AGREEMENT WITH THE FOLLOWING STATEMENT:

Whatcom County Disclaims any warranty of merchantability or warranty of fitness of this map for any particular purpose, either express or implied. No representation or warranty is made concerning the accuracy, currency, completeness or quality of data depicted on this map. Any user of this map assumes all responsibility for use thereof, and further agrees to hold Whatcom County harmless from and against any damage, loss, or liability arising from any use of this map.

**ORDINANCE NO. \_\_\_\_\_**

**ESTABLISHING WHATCOM COUNTY CODE 2.126, WHATCOM COUNTY  
CLIMATE IMPACT ADVISORY COMMITTEE**

**WHEREAS**, a near consensus of the scientific community agrees that human activities are causing detrimental climate change, and historic pollution is already causing climate impacts that ensure some amount of future climate change will continue to occur for the foreseeable future; and

**WHEREAS**, the Whatcom County Council supports the 2015 United Nations Paris Agreement on Climate Change; and

**WHEREAS**, the Paris Agreement recognizes "the need for an effective and progressive response to the urgent threat of climate change on the basis of the best available scientific knowledge"; and

**WHEREAS**, the Paris Agreement recognizes that people "may be affected not only by climate change, but also by the impacts of the measures taken in response to it"; and

**WHEREAS**, the Paris Agreement recognizes "the fundamental priority of safeguarding food security and ending hunger, and the particular vulnerabilities of food production systems to the adverse impacts of climate change"; and

**WHEREAS**, the Paris Agreement recognizes the need to take "into account the imperatives of a just transition of the workforce and the creation of decent work and quality jobs"; and

**WHEREAS**, the Paris Agreement affirmed "the importance of education, training, public awareness, public participation, public access to information and cooperation at all levels" regarding climate change "; and

**WHEREAS**, the Paris Agreement recognized "the importance of the engagement of all levels of government" regarding climate change; and

**WHEREAS**, in 2007 Whatcom County adopted a Climate Action Plan to reduce the emissions that cause climate change in both municipal operations and the community at large; and

**WHEREAS**, one of the proposed future steps of the 2007 Climate Action Plan was the creation of a Climate and Energy Advisory Committee to provide a conduit to educate and receive information from the community, provide oversight for implementation of the plan, and make future recommendations; and

**WHEREAS**, in 2016 the Whatcom County Council added Policy 10D-6 to the Comprehensive Plan calling for the creation of a Climate Impact Advisory Committee to in part review the implementation of the 2007 Climate Action Plan.

**NOW THEREFORE BE IT ORDAINED**, by the Whatcom County Council, that Whatcom County Code Chapter 2.126, Whatcom County Climate Impact Advisory Committee, is hereby established as outlined in Exhibit A to this ordinance.

**BE IT FURTHER ORDAINED**, that the Whatcom County Council establishes the goal of 100% renewable energy use within County Operations ~~by 2025 and a goal of 100% renewable energy use in~~ and the larger Whatcom County community ~~by 2050~~, and directs the Whatcom County Climate Impact Advisory Committee to work diligently toward that goal.

**APPROVED** this \_\_\_\_\_ day of \_\_\_\_\_, 2017.

**ATTEST:**

**WHATCOM COUNTY COUNCIL  
WHATCON COUNTY, WASHINGTON**

\_\_\_\_\_  
Dana Brown Davis, Clerk of the Council

\_\_\_\_\_  
Barry Buchanan, Council Chair

**APPROVED AS TO FORM:**

**WHATCOM COUNTY EXECUTIVE  
WHATCON COUNTY, WASHINGTON**

\_\_\_\_\_  
Civil Deputy Prosecutor

\_\_\_\_\_  
Jack Louws, County Executive

(    ) Approved      (    ) Denied

Date Signed: \_\_\_\_\_

## **EXHIBIT A**

(ESTABLISHING WCC 2.126, CLIMATE IMPACT ADVISORY COMMITTEE)

### **Chapter 2.126**

### **WHATCOM COUNTY CLIMATE IMPACT ADVISORY COMMITTEE**

Sections:

**2.126.010 Established.**

**2.126.020 Purpose.**

**2.126.030 Function.**

**2.126.040 Membership – Term of office.**

**2.126.010 Established.**

There is hereby established the Whatcom County Climate Impact Advisory Committee.

**2.126.020 Purpose.**

The Whatcom County Climate Impact Advisory Committee provides review and recommendations to the Whatcom County Council and Executive on issues related to the preparation and adaptation for, and the prevention and mitigation of, impacts of climate change.

**2.126.030 Function.**

To advise the County Council or the Executive on the following functions:

- A. Evaluating and reporting on Whatcom County's compliance with meeting targets for greenhouse gas reduction set forth in the 2007 Climate Action Plan, and setting targets, evaluating and reporting on the 100% renewable energy goal established in Ordinance 2017-\_\_\_\_\_; and
- B. Periodically recommending to the County Council new or revised targets that meet or exceed state and federal greenhouse gas reduction and renewable energy goals; and
- C. Updating the Climate Action Plan, at a minimum every five years, or as needed to meet targets; and
- D. Make recommendations to the Whatcom County Council about policies and budget priorities that will support a stable and just transition for workers and businesses, wherever possible encouraging and supporting a predictable shift towards clean energy and low carbon alternatives within the same or similar industry; and
- E. Review available science, and recommend to the County Council the adoption of standardized guidelines for anticipated future sea level rise, risk of flood, fires, drought and other impacts of climate change to be used in community planning and capital facilities development; and
- F. Recommending updates to the Whatcom County Comprehensive Plan in accordance with meeting Whatcom County's goals to mitigate climate change, and prevent, adapt to, and prepare for climate change impacts; and

G. Recommend updates to Whatcom County land use policies and development regulations to support Whatcom County's goals to prevent, adapt to, and prepare for climate change impacts.

H. Serve as a conduit for public education, information exchange, and engagement in support of Whatcom County's climate change mitigation and impact prevention, adaptation, and preparation goals.

I. Make recommendations relevant to Whatcom County's climate change mitigation and impact prevention, adaptation and preparation goals to the Whatcom County Council and Whatcom County Executive regarding state and federal policy priorities.

**2.126.040 Membership – Term of office.**

A. The committee shall consist of 11 voting members. A minimum of seven of the members will have previous work or educational experience in subjects including climate change, renewable energy development, energy conservation, waste reduction and recycling, farming, food security, land use planning, municipal government and flood mitigation and planning. Elected officials and staff from the cities within the county are eligible and encouraged to participate as members. A quorum shall consist of at least half of the appointed members.

B. The County Council shall appoint the committee members. Member terms will be three years; provided, that the terms of members first appointed will be staggered so that five of the initial committee members shall be appointed for two years. Members of the committee shall serve without compensation.

**2.126.050 Organization – Meetings.**

Meetings of the committee shall be open and accessible to the public and shall be subject to the Open Public Meetings Act. At every meeting, the committee will schedule an open session to take public comment on issues associated with the committee. Written records of meetings, resolutions, research, findings and recommendations shall be kept and such records shall be public. The committee shall adopt its own rules and procedures for the conduct of business. The committee shall elect a chairperson from among its members who shall preside at its meetings. The committee shall determine its meeting schedule and agenda, but shall meet at least quarterly. The committee may form and appoint ad hoc committees to work on specific issues, so long as at least two committee members are also members of each ad hoc committee.

**2.126.060 Committee staffing.**

The committee is encouraged to operate and hold its meetings as independent of county staffing and resources as possible. Staffing and other resources for the Committee shall be requested through the County Executive's Office. The committee is authorized to request from the executive's office information from administrative departments as necessary.